

# TRULOK SUSPENSION SYSTEMS COMPONENTS AND ASSEMBLIES

- T1** EXPOSED GRID-PRELUDE 24 AND 15 LAYOUT OPTIONS
- T2** PRELUDE 24 STITCHED EXPOSED GRID SECTIONS
- T3** PRELUDE 15 STITCHED EXPOSED GRID SECTIONS
- T4** PRELUDE 24 TL SHOWING CONNECTION AND EXPANSION UNDER CONDITIONS OF FIRE
- T5** PRELUDE 24 XL SHOWING CONNECTION AND EXPANSION UNDER CONDITIONS OF FIRE
- T6** ALTERNATIVE HANGER METHODS
- T7** SUGGESTED ALTERNATIVE SOFFIT FIXINGS
- T8** ALTERNATIVE PERIMETER OPTIONS
- T9** PRELUDE 24 WITH 600 X 600 PANELS
- T10** PRELUDE15 WITH 600 X 600 PANELS
- T11** ATTACHMENTS FOR TRULOK PRELUDE 24 AND 15 EXPOSED GRIDS
- T12** TYPICAL PARTITION HEAD FIXINGS USING TRULOK FIXING CLIPS
- T13** PARTITION HEAD FIXINGS USING CLIPS FOR PRELUDE 15 AND SILHOUETTE XL
- T14** SEMI-CONCEALED SYSTEMS WITH SL2 LONG SPAN PANELS
- T15** GRID CONSTRUCTION FOR 300 x 1500 AND 300 x 1800 SL2 OR K2C2 PLANKS
- T16** SL2 OR K2C2 PLANKS SPANNING BETWEEN CONTINUOUS LIGHTING TRUNKING
- T17** SLOTTED AND UNSLOTTED BANDRASTER ASSEMBLIES FOR SL2 OR BOARD PLANK SYSTEMS
- T18** BANDRASTER TARTAN GRID USING 90° CONNECTORS OR CROSSING ELEMENTS
- T19** BANDRASTER GRID CONNECTIONS
- T20** SLOPING UPSTAND CHANGE OF LEVEL AND SLOPING CEILING TO WALL
- T21** VERTICAL UPSTAND OR BULKHEAD USING 'F' SECTION TRIM
- T22** VERTICAL UPSTAND OR BULKHEAD USING 'F' UPSTAND TRIMS TO PROVIDE UPSTAND DEMOUNTABILITY
- T23** VERTICAL UPSTAND FOR TRULOK PRELUDE 24 AND 15 SUITABLE FOR UP TO 600mm HEIGHT
- T24** ALTERNATIVE VERTICAL UPSTAND FOR TRULOK PRELUDE 24 AND 15 SUITABLE FOR 600mm OR LESS
- T25** FLOATING CEILING EDGE DETAIL
- T26** SILHOUETTE XL END CONNECTIONS AND PERIMETER DETAILS

The designs and layouts shown are typical and not definitive. Users should verify that their proposed installations are suitable for the intended purpose. Armstrong are continuously developing their ceiling systems. It is therefore recommended that you contact our Internal Technical Sales (Tel : FREEPHONE 0800 371 849) whenever you are considering ceiling specifications. This will help to ensure correct suspension system components are specified and used.

**FOR ITEM NUMBERS SEE  
TRULOK SUSPENSION  
SYSTEMS BROCHURE**

**600 X 1200 MODULES**

**Fig 1.**  
(Preferred layout)  
Layout for 600 x 1200 panels parallel to Cross Tee.  
Main Runners at 1200 centres with 1200 Cross Tees spanning at 600 centres.

**Fig 2.**  
Layout for 600 x 1200 panels parallel to Main Runner.  
Main Runners at 600 centres with 600 Cross Tees spanning at 1200 centres. Recommended for Ceramaguard

**Fig 3.**  
Layout for 600 x 1200 panels parallel to Main Runner.  
Main Runners at 1200 centres with 1200 Cross Tees spanning at 1200 centres and supporting additional 1200 Cross Tees parallel to Main Runner.

**600 X 600 MODULES**

**Fig 4.**  
(Preferred layout)  
Layout for 600 x 600 panels  
Main Runners at 1200 centres with 1200 Cross Tees spanning at 600 centres and supporting additional 600 Cross Tees at mid-points of 1200 Cross Tees.

**Fig 5.**  
Alternative layout for 600 x 600.  
Main Runners at 600 centres with 600 Cross Tees spanning at 600 centres. Recommended for Ceramaguard

**500 X 500 MODULES**

**Fig 6.**  
Layout for 500 x 500 panels  
Main Runners at 1000 centres with 1000 Cross Tees at 500 centres and 500 Cross Tees at mid-points of 1000 Cross Tees.  
NOTE: Hangers at 1250 centres along Main Runners.

Fig 1.

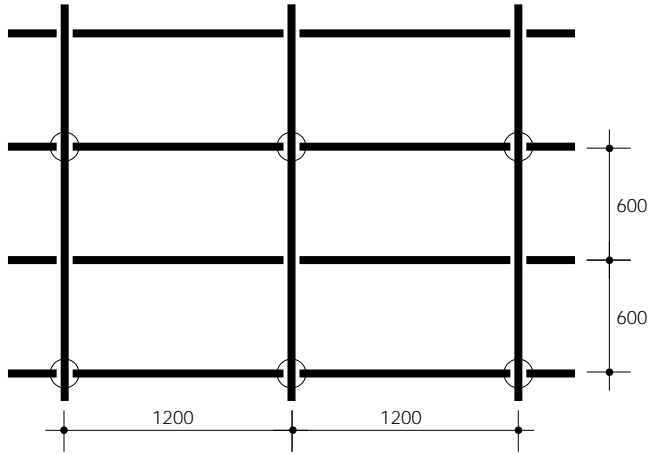

Fig 2.

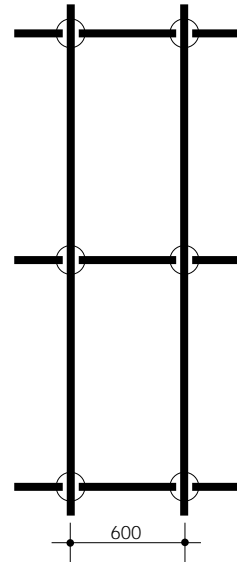

Fig 3.

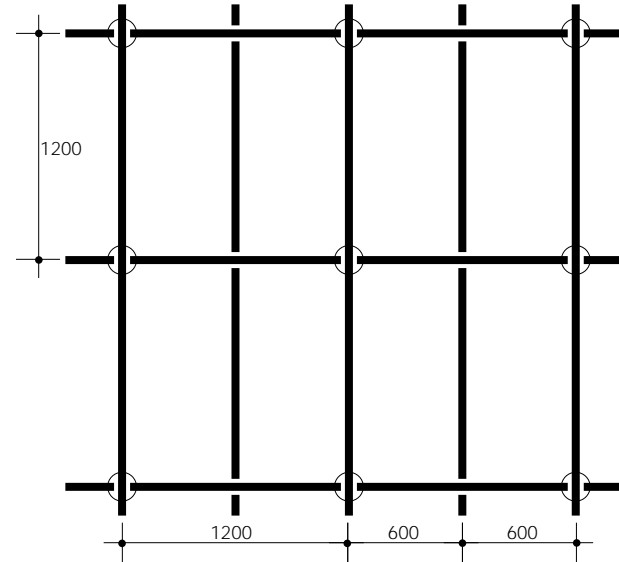

Fig 4.

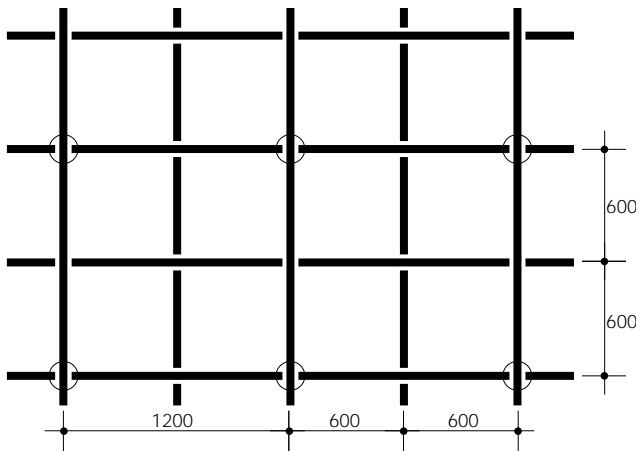

Fig 5.

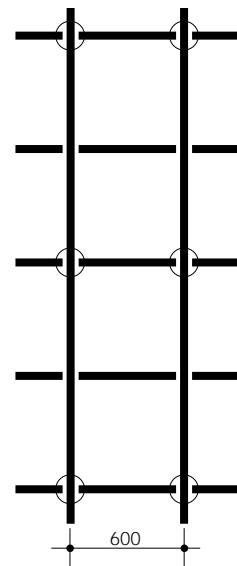
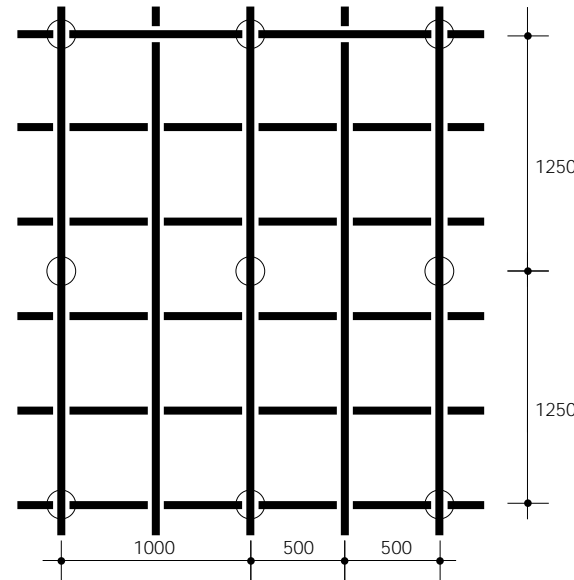

Fig 6.



FOR ITEM NUMBERS SEE  
TRULOK SUSPENSION  
SYSTEMS BROCHURE

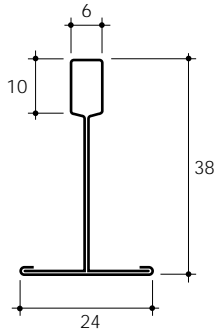
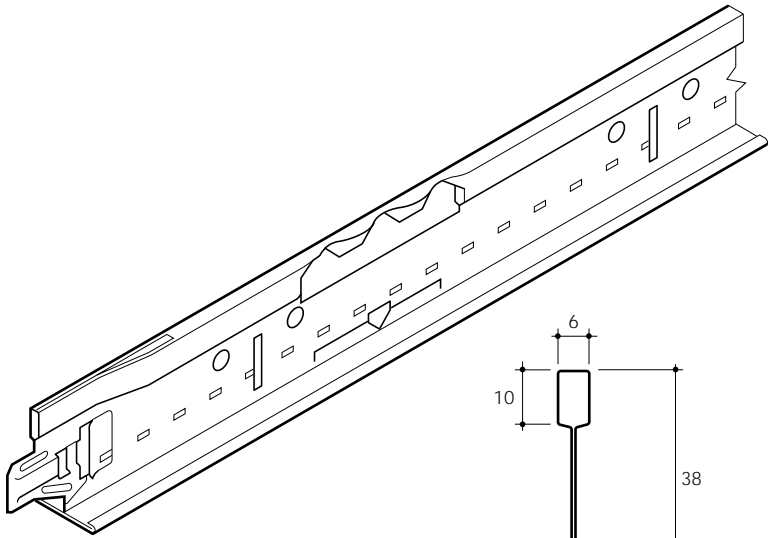

Fig 1.  
UNIVERSAL MAIN RUNNER

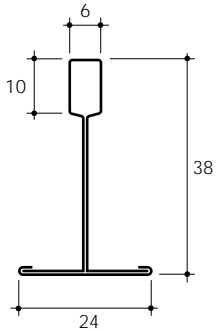
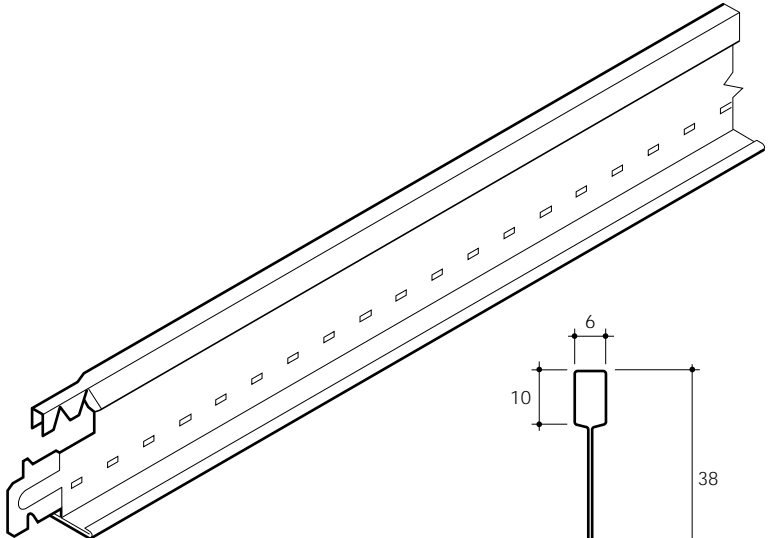

Fig 2.  
TL HOOK CROSS TEE

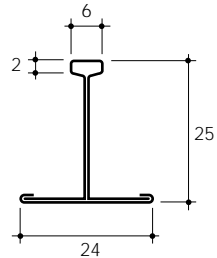
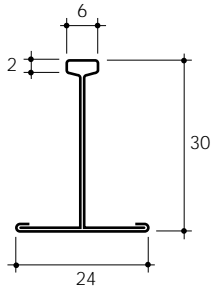
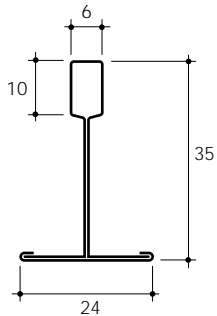
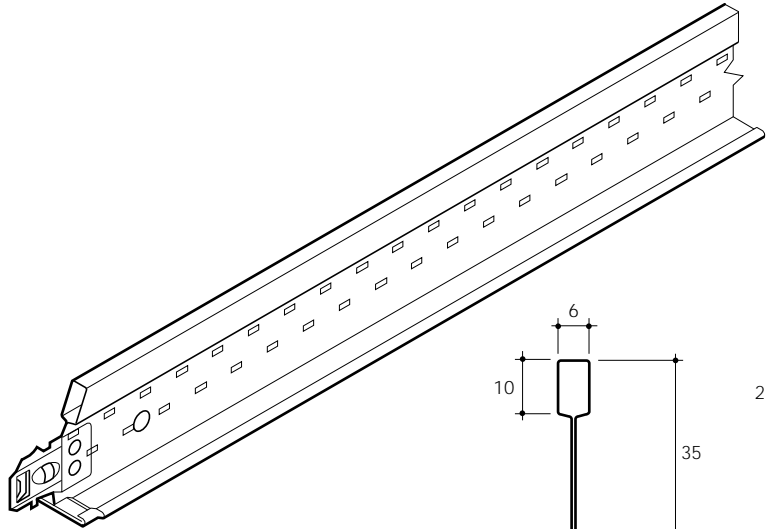

Fig 3.  
XL STAB CROSS TEE

FOR ITEM NUMBERS SEE  
TRULOK SUSPENSION  
SYSTEMS BROCHURE

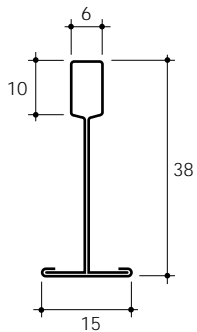
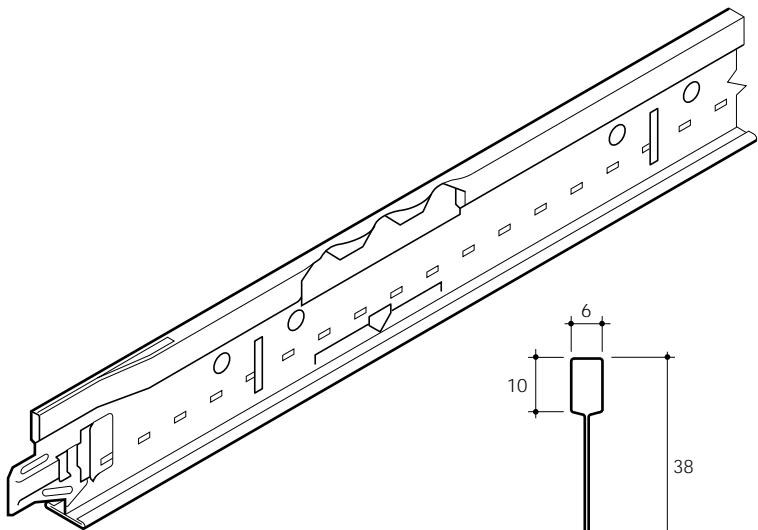

Fig 1.  
UNIVERSAL MAIN RUNNER

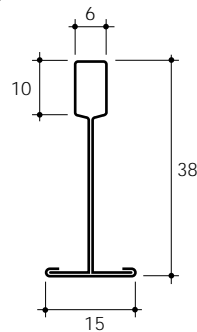
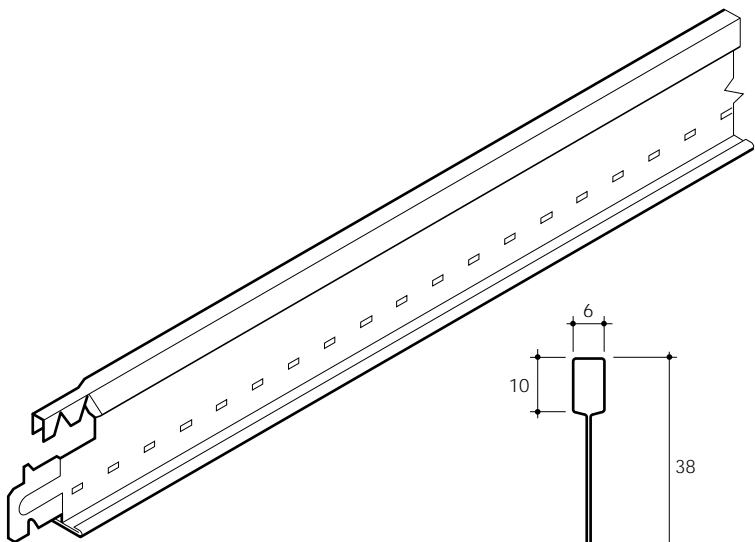

Fig 2.  
TL HOOK CROSS TEE

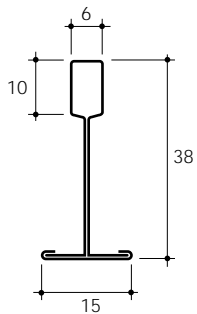
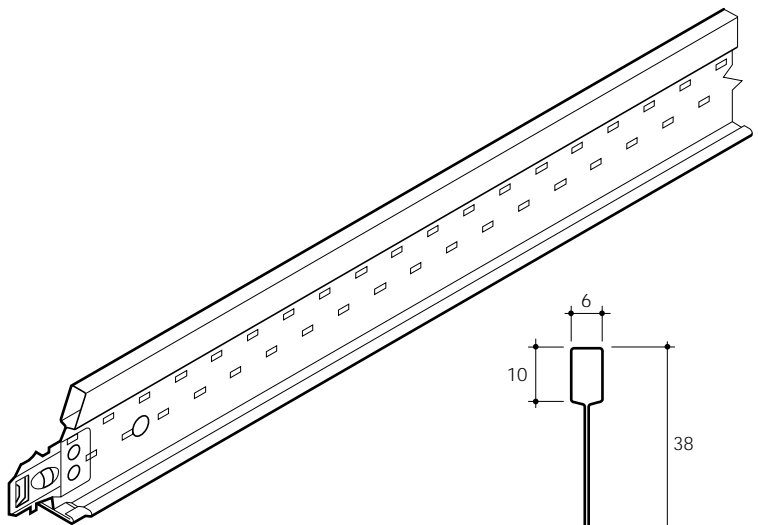
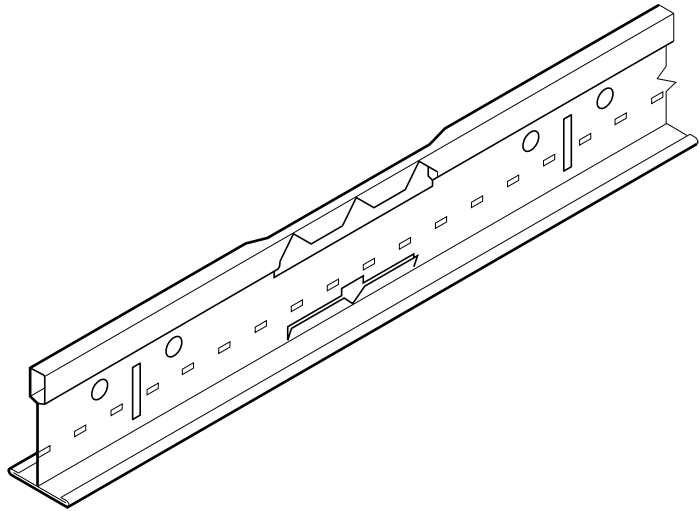
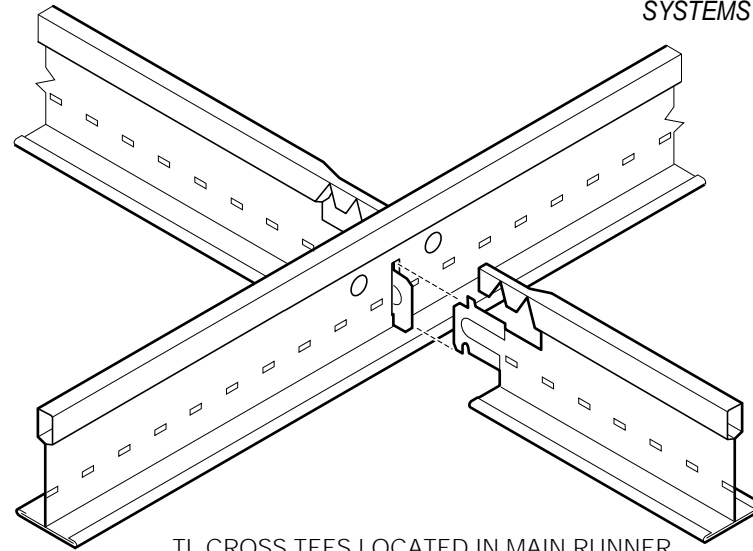

Fig 3.  
XL STAB CROSS TEE

FOR ITEM NUMBERS SEE  
TRULOK SUSPENSION  
SYSTEMS BROCHURE



UNIVERSAL MAIN RUNNER EXPANSION DETAIL



TL CROSS TEES LOCATED IN MAIN RUNNER

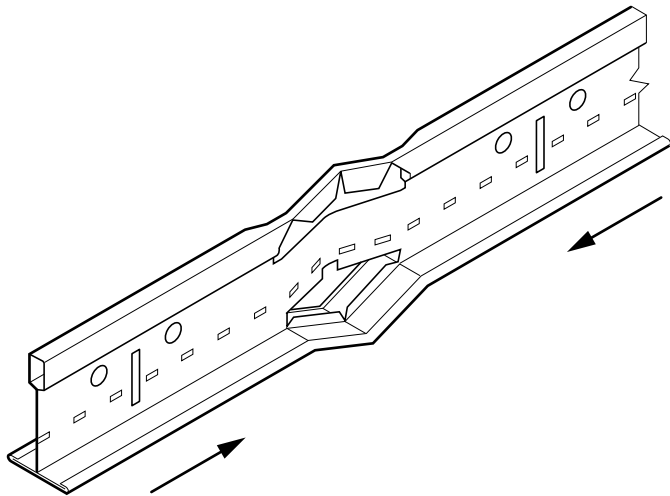

UNIVERSAL MAIN RUNNER UNDER EXPANSION

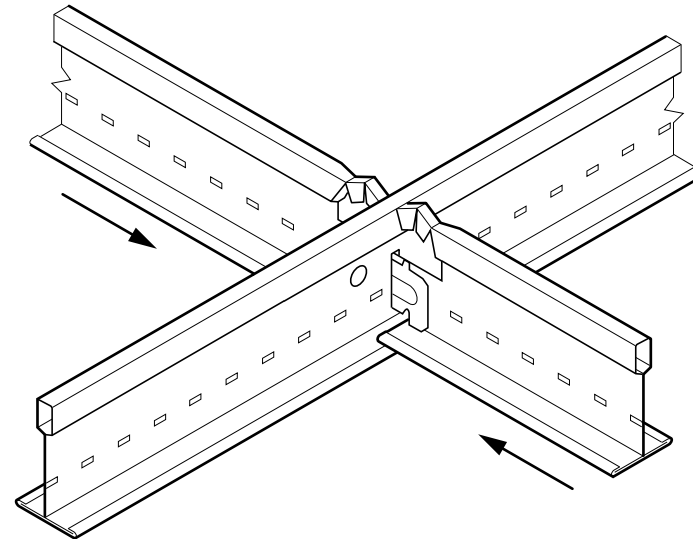

TL CROSS TEES UNDER EXPANSION

FOR ITEM NUMBERS SEE  
TRULOK SUSPENSION  
SYSTEMS BROCHURE

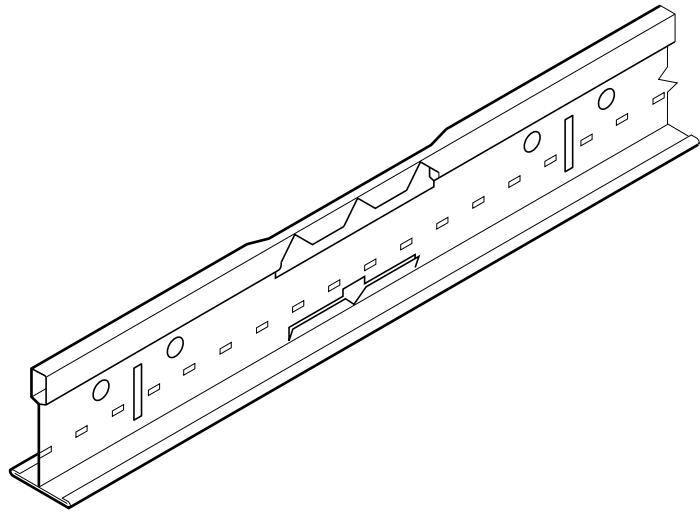

UNIVERSAL MAIN RUNNER EXPANSION DETAIL

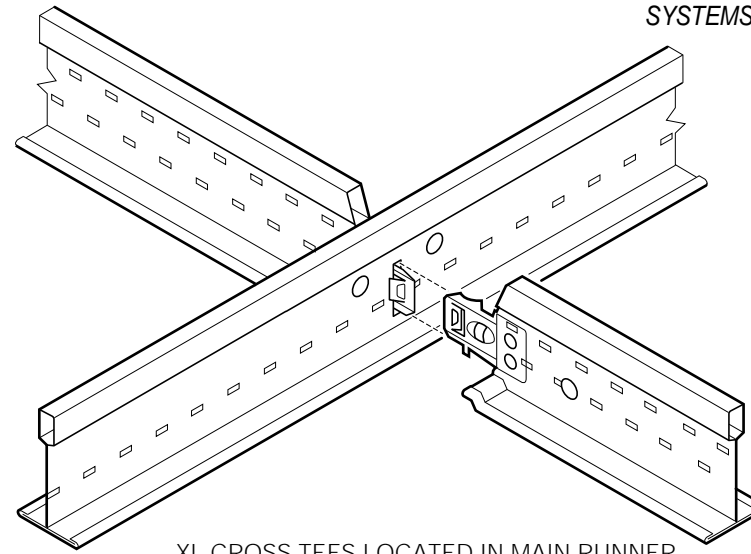

XL CROSS TEES LOCATED IN MAIN RUNNER

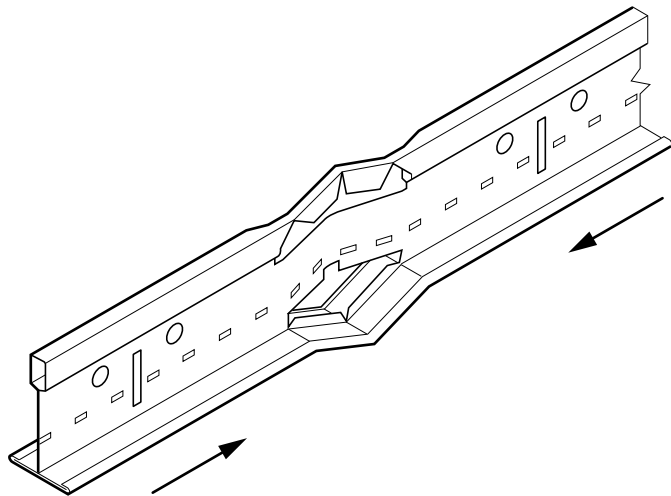

UNIVERSAL MAIN RUNNER UNDER EXPANSION

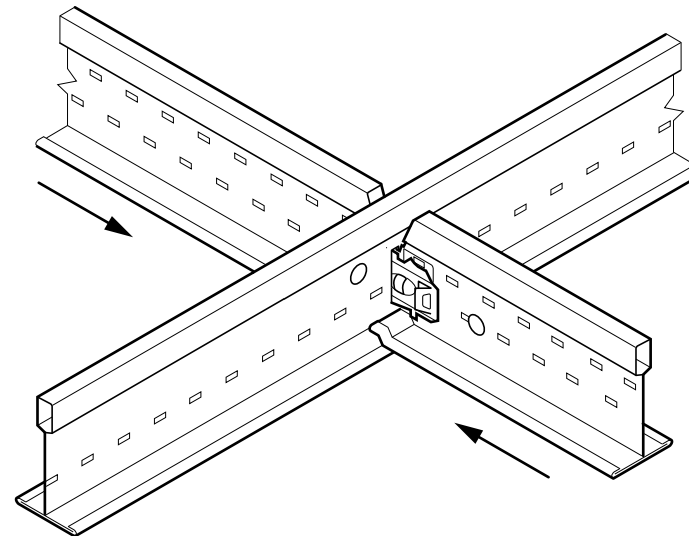

XL CROSS TEES UNDER EXPANSION

FOR ITEM NUMBERS SEE  
TRULOK SUSPENSION  
SYSTEMS BROCHURE

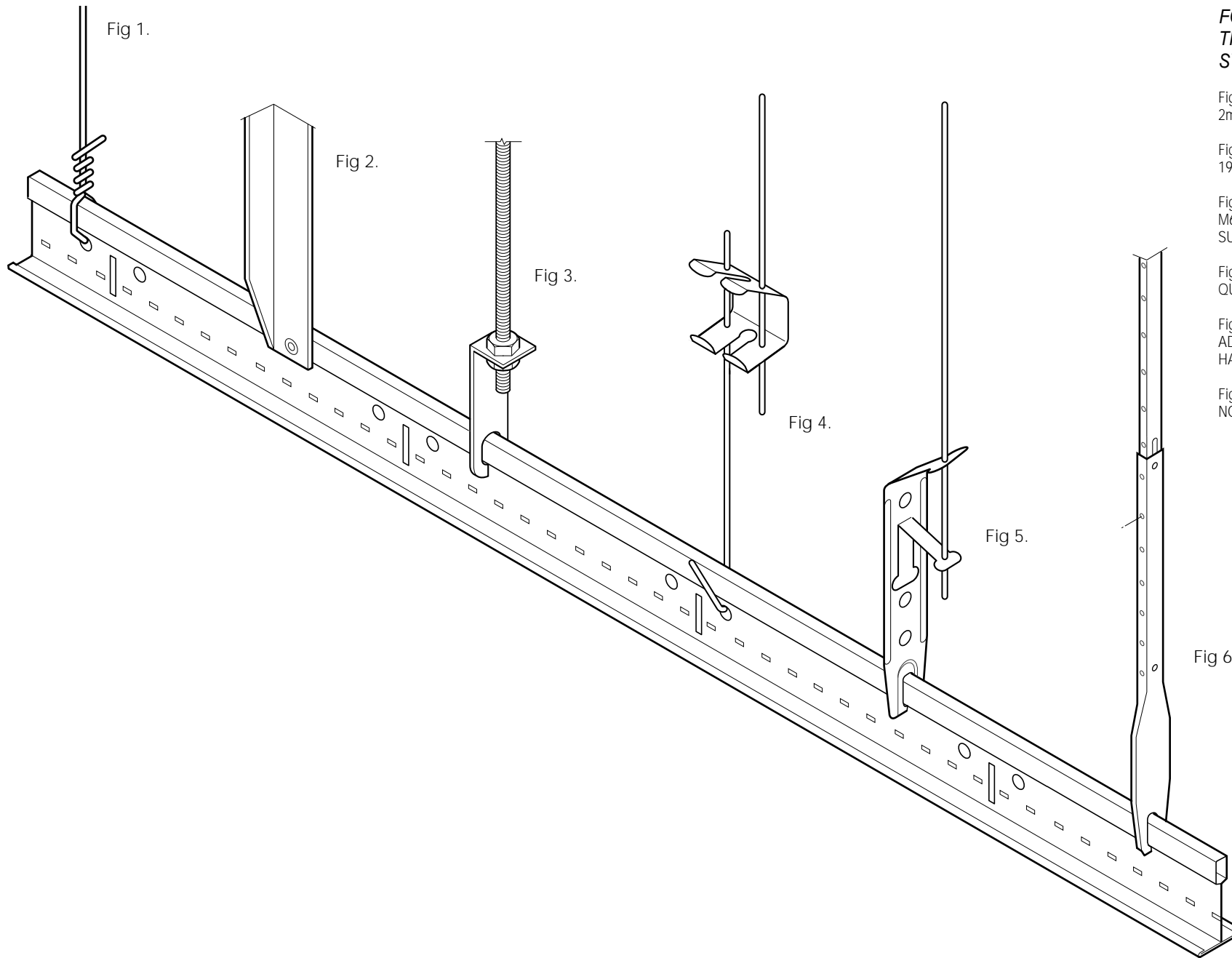

Fig 1.  
2mm SUSPENSION WIRE

Fig 2.  
19mm x 19mm SUSPENSION ANGLE

Fig 3.  
M6 THREADED WIRE ROD WITH  
SUSPENSION CLIP

Fig 4.  
QUICK HANGER

Fig 5.  
ADJUSTABLE SUSPENSION  
HANGER

Fig 6.  
NONIUS HANGER

**FOR ITEM NUMBERS SEE  
TRULOK SUSPENSION  
SYSTEMS BROCHURE**

Fig 1.  
2mm SUSPENSION WIRE AND  
ANGLE BRACKET

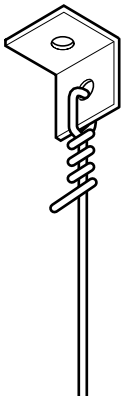

Fig 2.  
19mm x 19mm SUSPENSION ANGLE

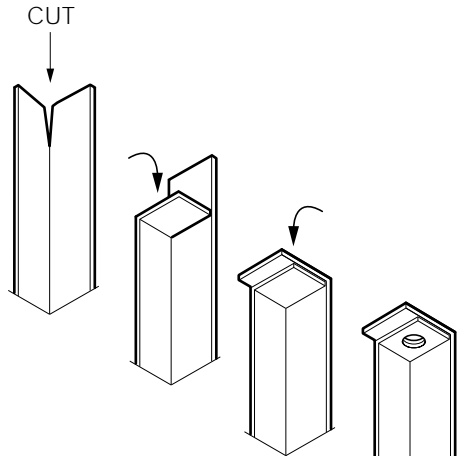

Fig 3.  
M6 THREADED ROD WITH SOFFIT  
INSERT

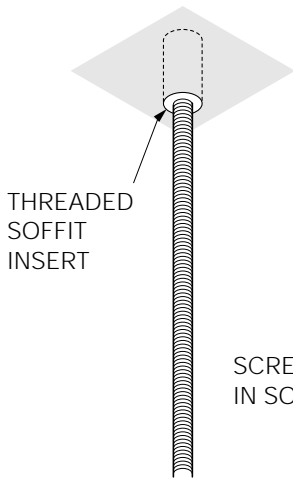

Fig 4.  
QUICK HANGER AND SCREW EYE

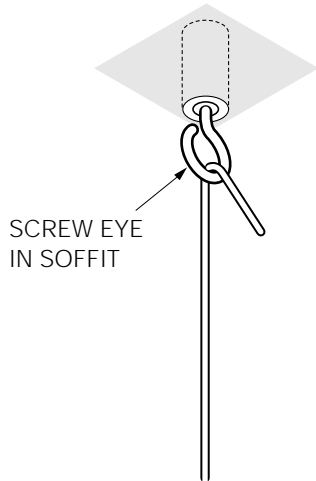

Fig 5.  
ADJUSTABLE SUSPENSION  
HANGER AND ANGLE BRACKET

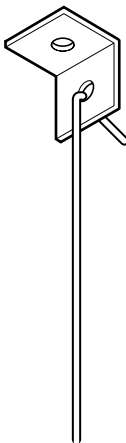
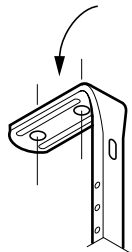
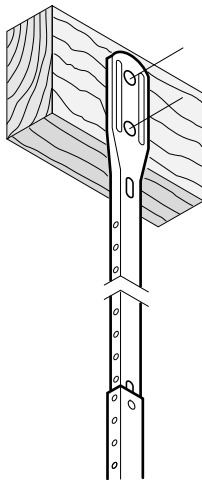

Fig 6.  
NONIUS HANGER TO TIMBER JOIST  
OR SOFFIT FIXING



SOFFIT FIXING

Fig 1.

METHOD OF FORMING  
SOFFIT FIXING  
Fig 2.

Fig 3.

Fig 4.

Fig 5.

Fig 6.



FOR ITEM NUMBERS SEE  
TRULOK SUSPENSION  
SYSTEMS BROCHURE

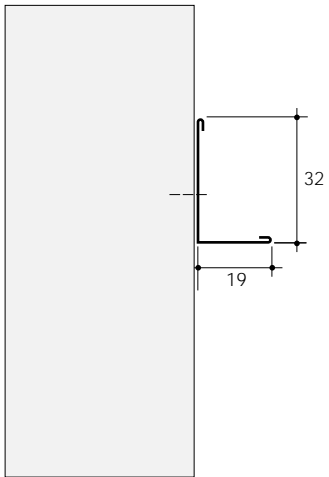

WALL ANGLE

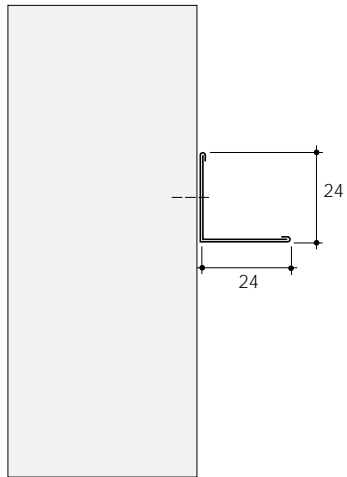

WALL ANGLE

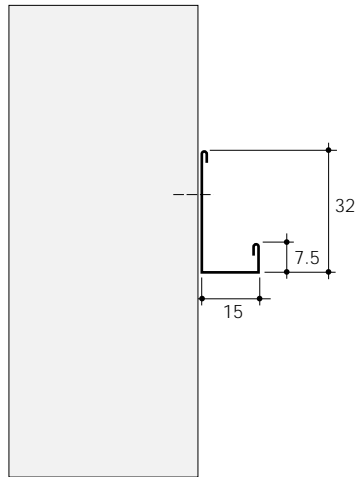

UNEQUAL U PROFILE

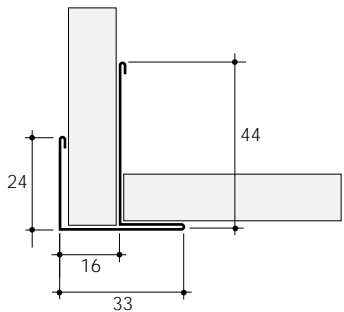

'F' UPSTAND

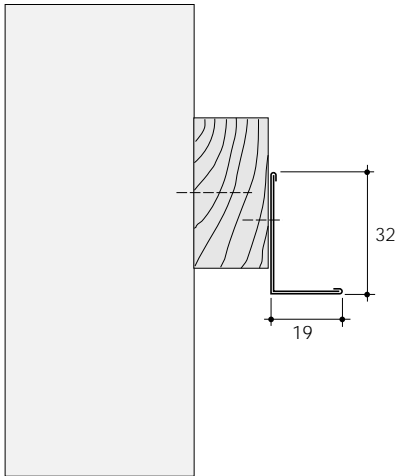

ANGLE TO TIMBER GROUND

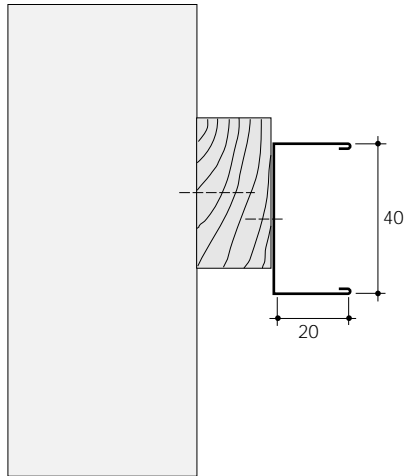

CHANNEL TO TIMBER GROUND

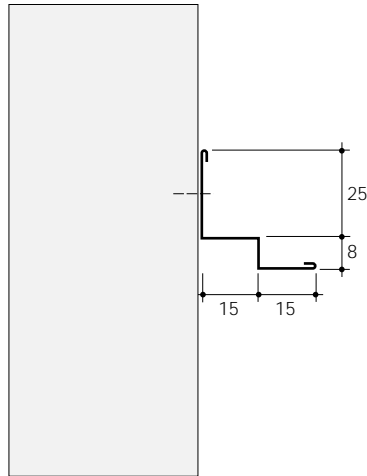

MICROLOOK SHADOWLINE

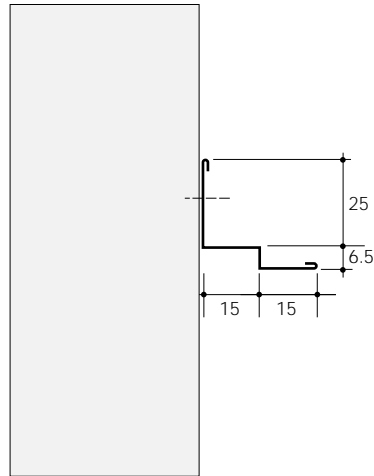

TEGULAR SHADOWLINE

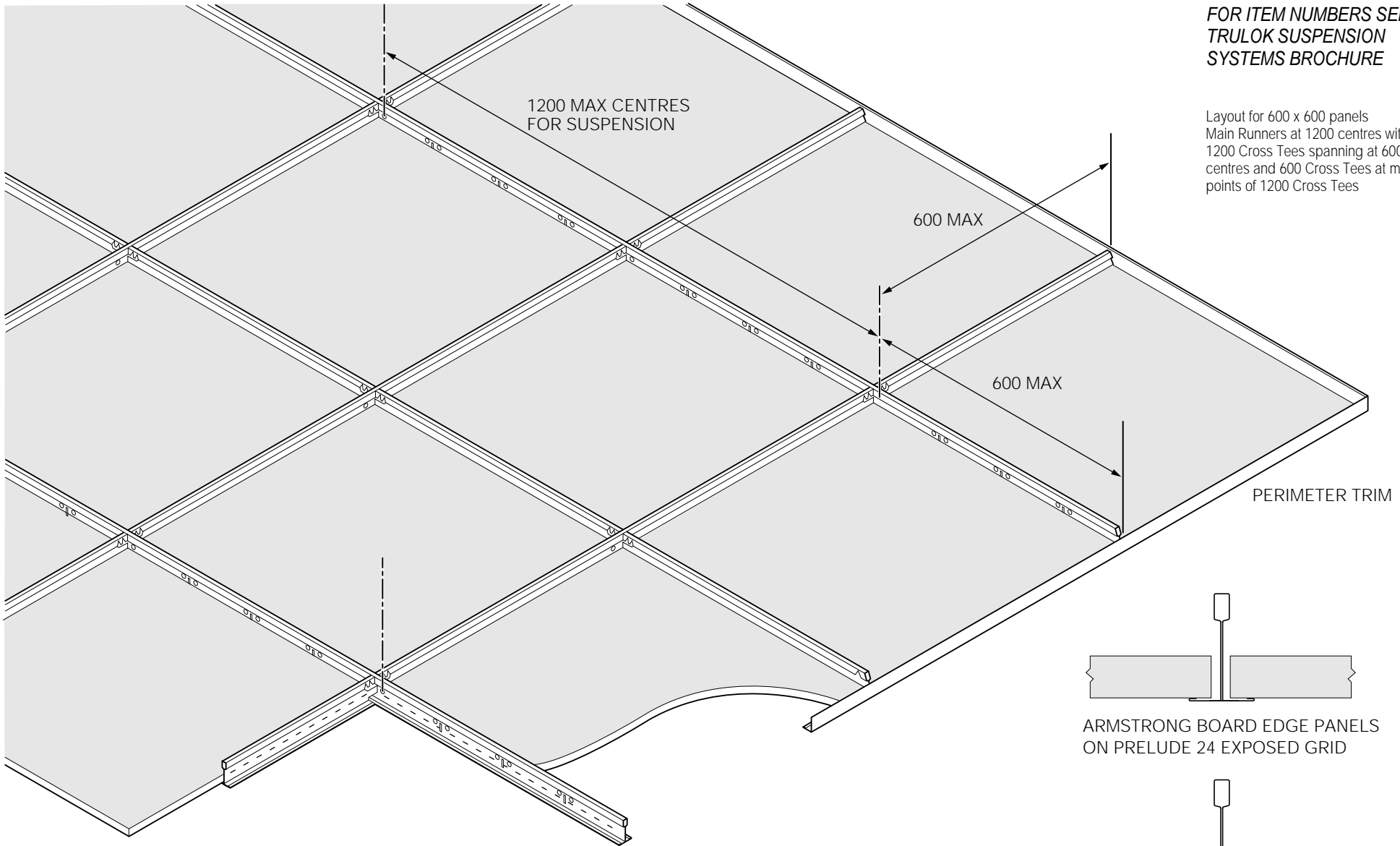

FOR ITEM NUMBERS SEE  
TRULOK SUSPENSION  
SYSTEMS BROCHURE

Layout for 600 x 600 panels  
Main Runners at 1200 centres with  
1200 Cross Tees spanning at 600  
centres and 600 Cross Tees at mid  
points of 1200 Cross Tees

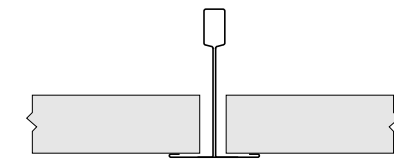

ARMSTRONG BOARD EDGE PANELS  
ON PRELUDE 24 EXPOSED GRID

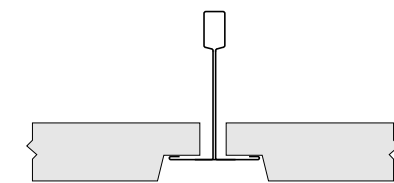

ARMSTRONG TEGULAR EDGE PANELS  
ON PRELUDE 24 EXPOSED GRID

FOR ITEM NUMBERS SEE  
TRULOK SUSPENSION  
SYSTEMS BROCHURE

Layout for 600 x 600 panels  
Main Runners at 1200 centres with  
1200 Cross Tees spanning at 600  
centres and 600 Cross Tees at mid  
points of 1200 Cross Tees

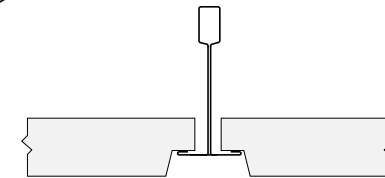
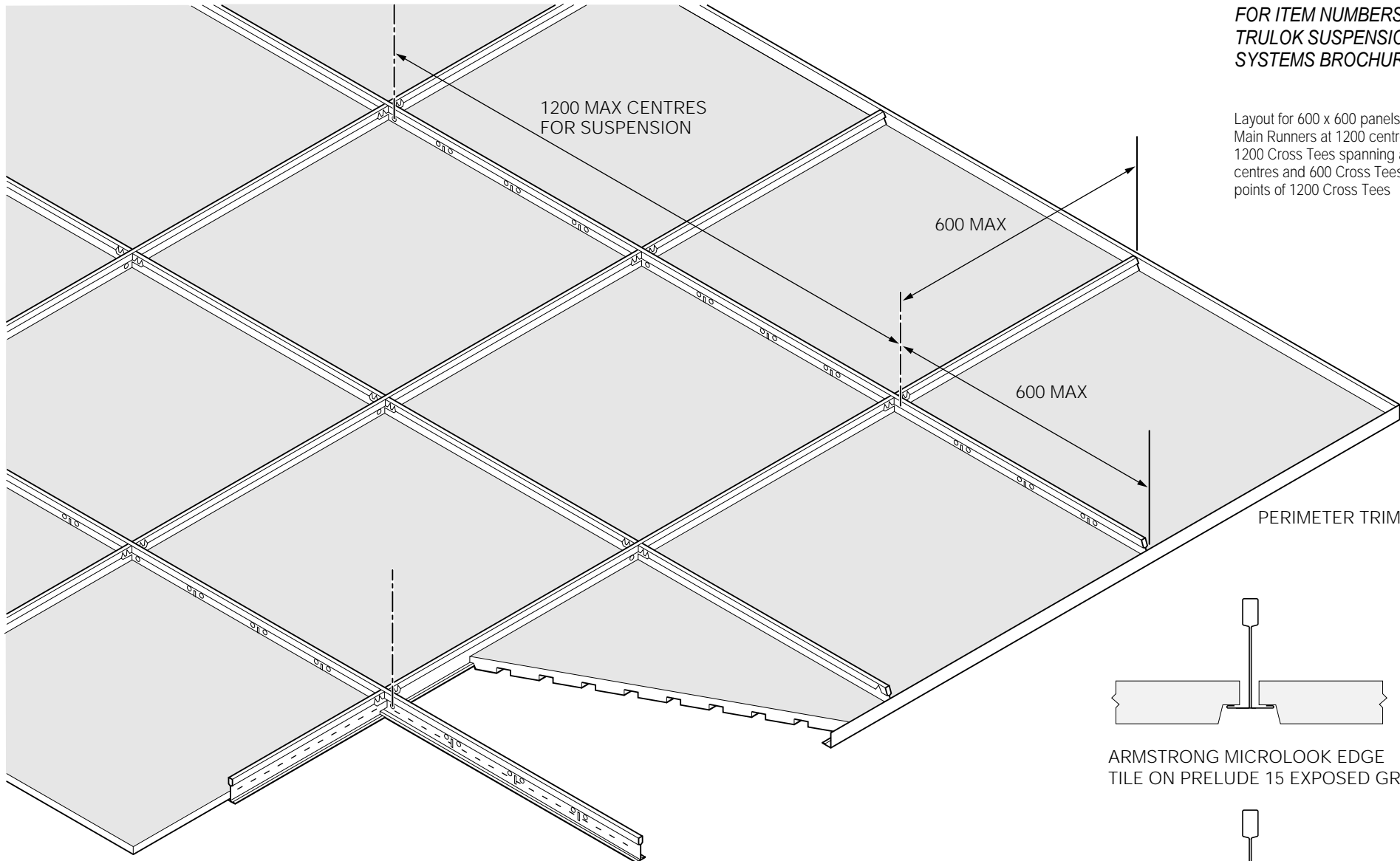

ARMSTRONG MICROLOOK EDGE  
TILE ON PRELUDE 15 EXPOSED GRID

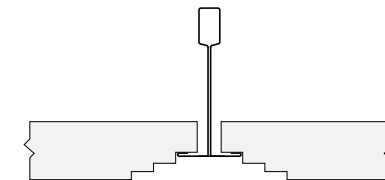

ARMSTRONG FEATURE EDGE DETAILS  
ON PRELUDE 15 EXPOSED GRID

FOR ITEM NUMBERS SEE  
TRULOK SUSPENSION  
SYSTEMS BROCHURE

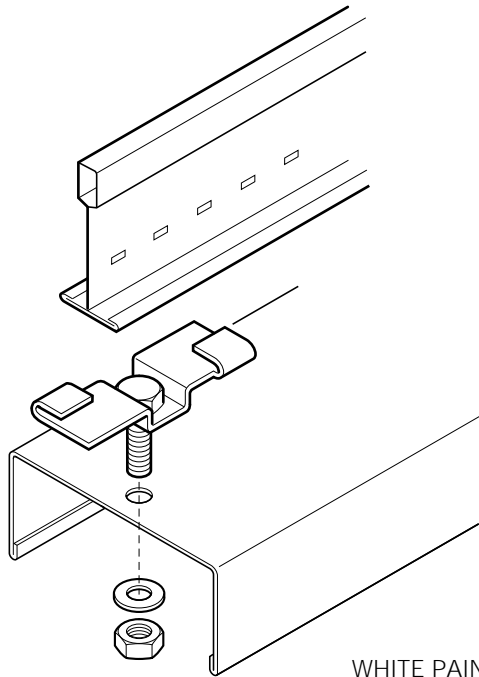
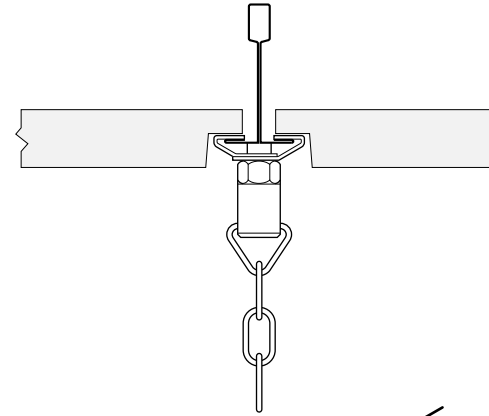
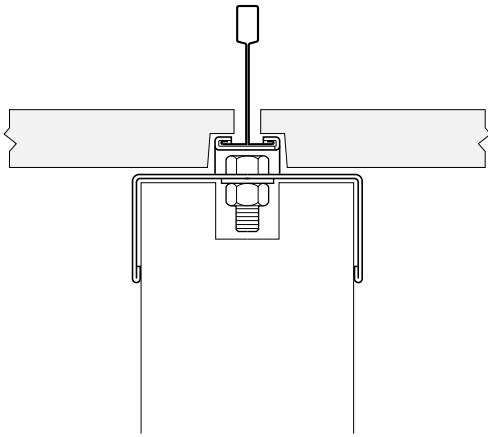

WHITE PAINTED 2-CLAW CLIP  
FOR USE WITH PRELUDE 15 GRID SYSTEMS

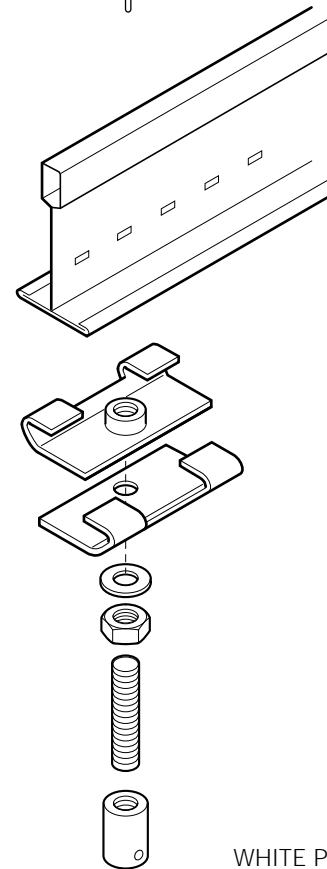

WHITE PAINTED 4-CLAW (2 PIECE) CLIP  
FOR USE WITH PRELUDE 24 GRID SYSTEMS

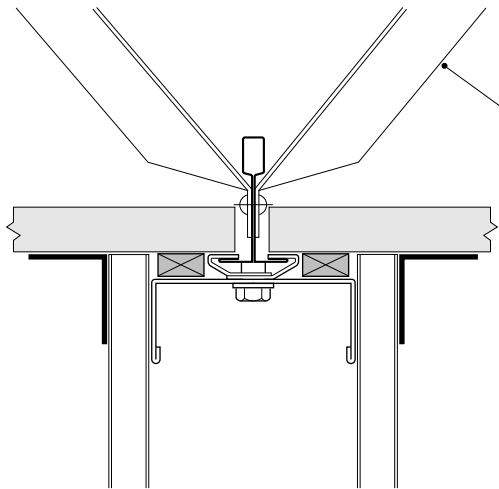

BRACING TO BE DETERMINED BY OTHERS

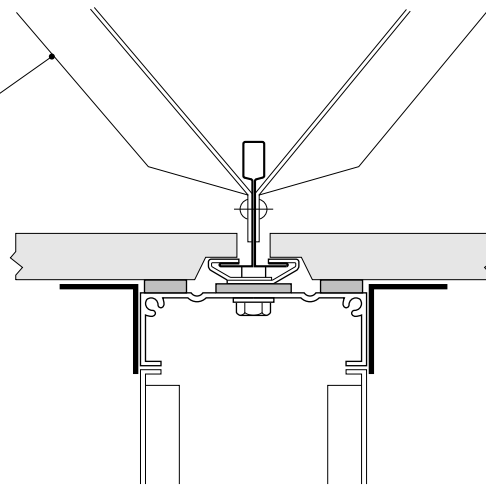

**FOR ITEM NUMBERS SEE  
TRULOK SUSPENSION  
SYSTEMS BROCHURE**

NB.1.  
The drawings on this page show 4-claw fixing clips used with the Prelude 24 (24mm) exposed system. Partitions may also be attached to the Prelude 15 (15mm) exposed systems by using the 2-claw clip shown on sheet T11.

NB.2.  
Types and loads of Partitioning can vary considerably. The advice of a structural engineer may be necessary to determine bracing requirements.

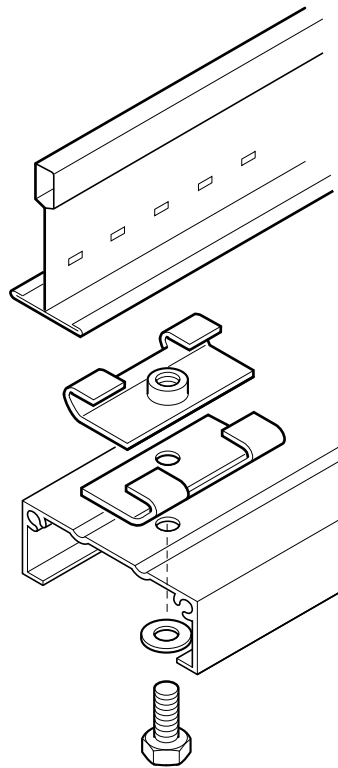
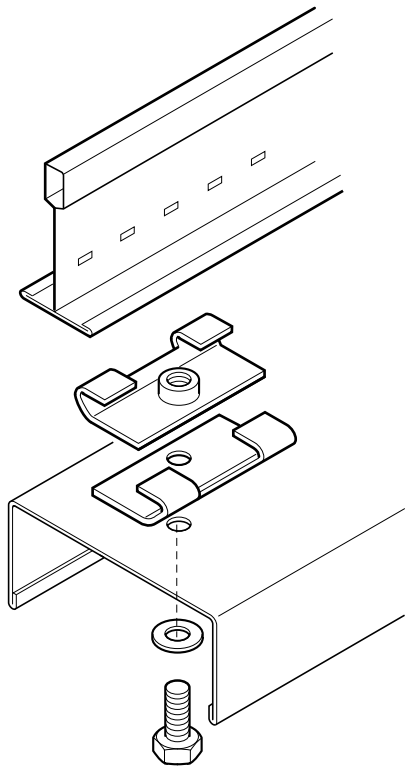

FOR ITEM NUMBERS SEE  
TRULOK SUSPENSION  
SYSTEMS BROCHURE

Fig 1.  
Partition Clip for Trulok Silhouette XL  
Grid Sections.

Fig 2.  
Partition Clip for Prelude 24 and 15  
Grid Sections.

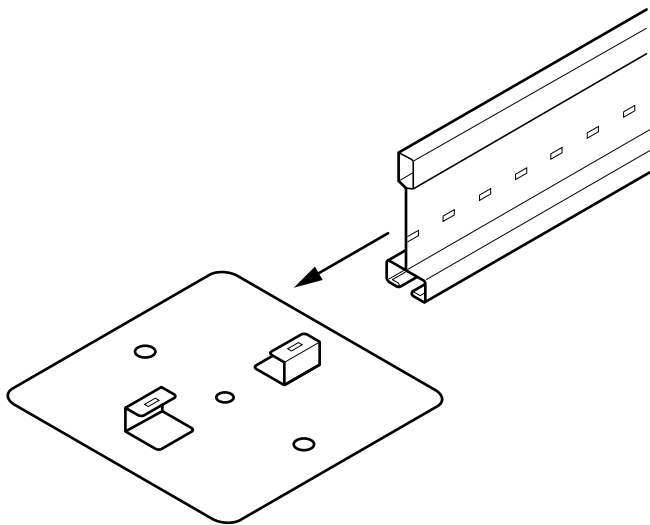
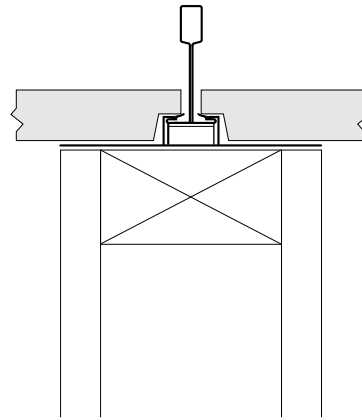
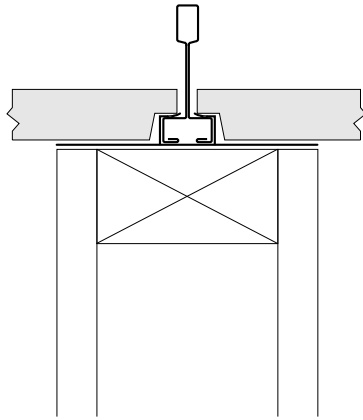

Fig 1.

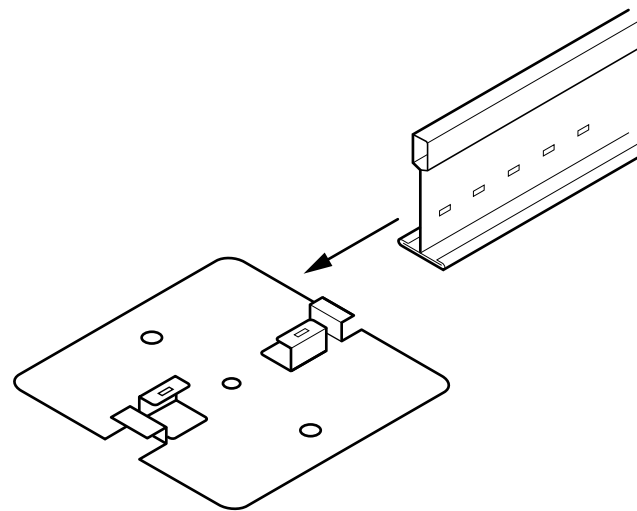
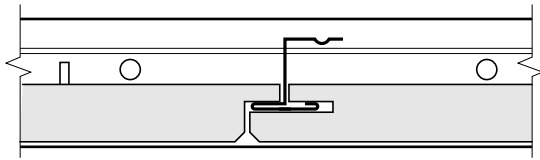
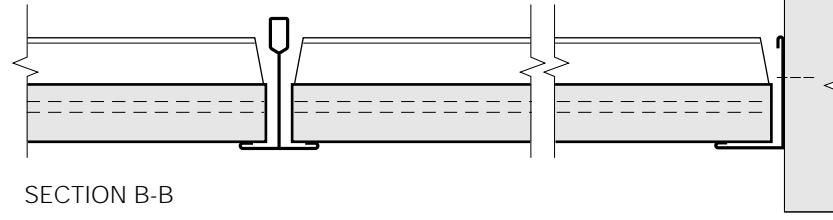

Fig 2.

FOR ITEM NUMBERS SEE  
TRULOK SUSPENSION  
SYSTEMS BROCHURE



SECTION A-A  
1200mm LONG PLANKS  
SUPPORTED BY 20.5mm DEEP Z SECTIONS  
CUT TO LENGTH



SECTION B-B

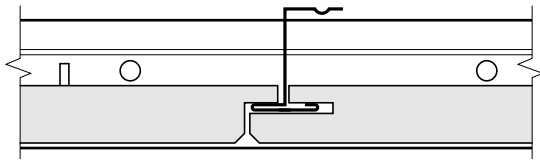
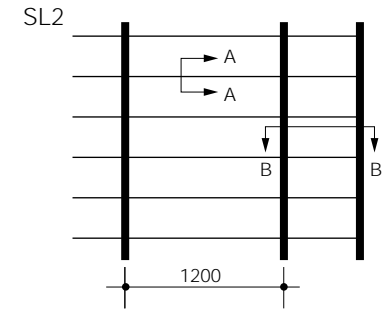

SECTION C-C  
1500mm OR 1800mm LONG PLANKS  
SUPPORTED BY 32mm DEEP Z SECTIONS

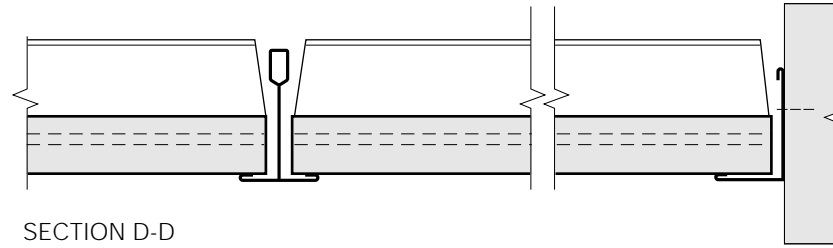

SECTION D-D

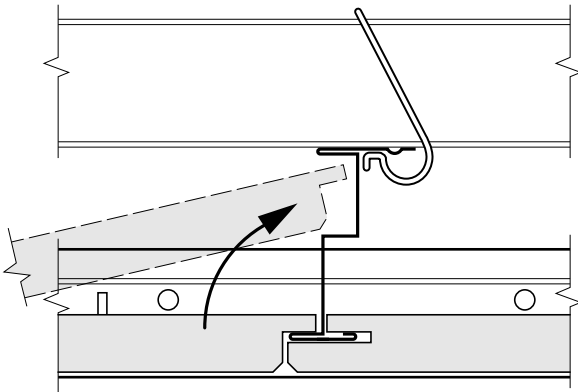
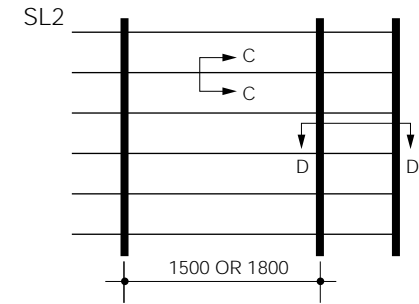

SECTION E-E  
>or= 2000mm LONG PLANKS  
SUPPORTED BY DOUBLE HEIGHT Z SECTIONS  
FIXED TO PRIMARY GRID

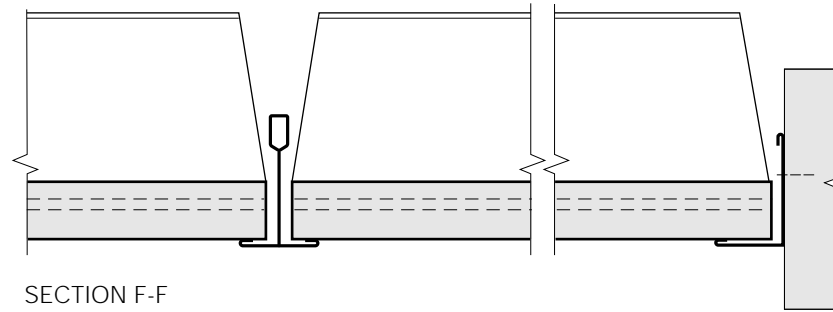

SECTION F-F

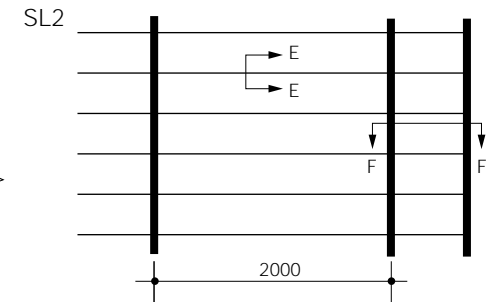

FOR ITEM NUMBERS SEE  
TRULOK SUSPENSION  
SYSTEMS BROCHURE

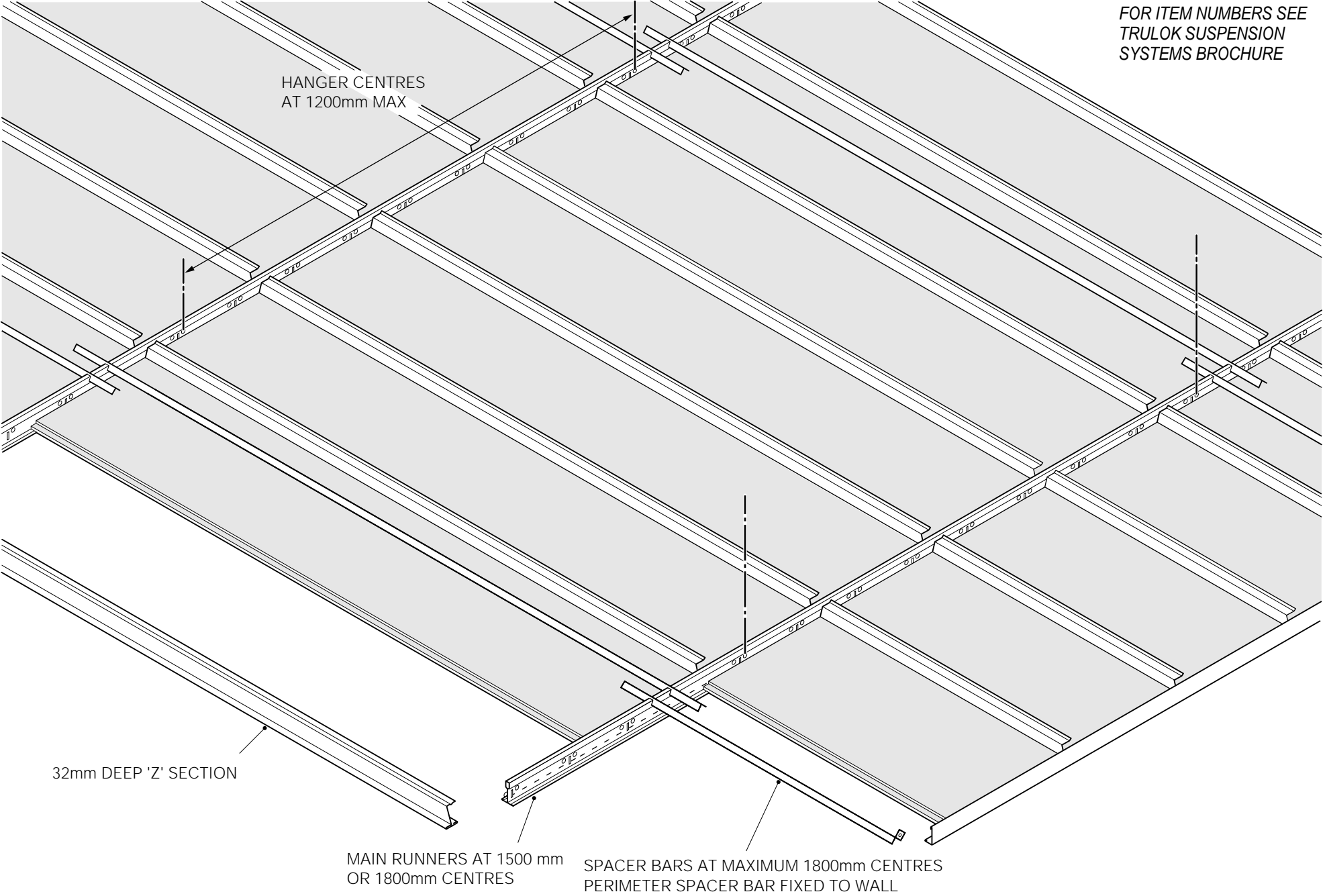

ARMSTRONG TRULOK  
SUSPENSION SYSTEMS

*GRID CONSTRUCTION FOR 300 x 1500 AND  
300 x 1800 SL2 OR K2C2 PLANKS*

THESE DESIGNS ARE TYPICAL, NOT DEFINITIVE.  
ALL DIMENSIONS INDICATED ARE IN MILLIMETRES

Armstrong

T115



FOR ITEM NUMBERS SEE  
TRULOK SUSPENSION  
SYSTEMS BROCHURE

Armstrong

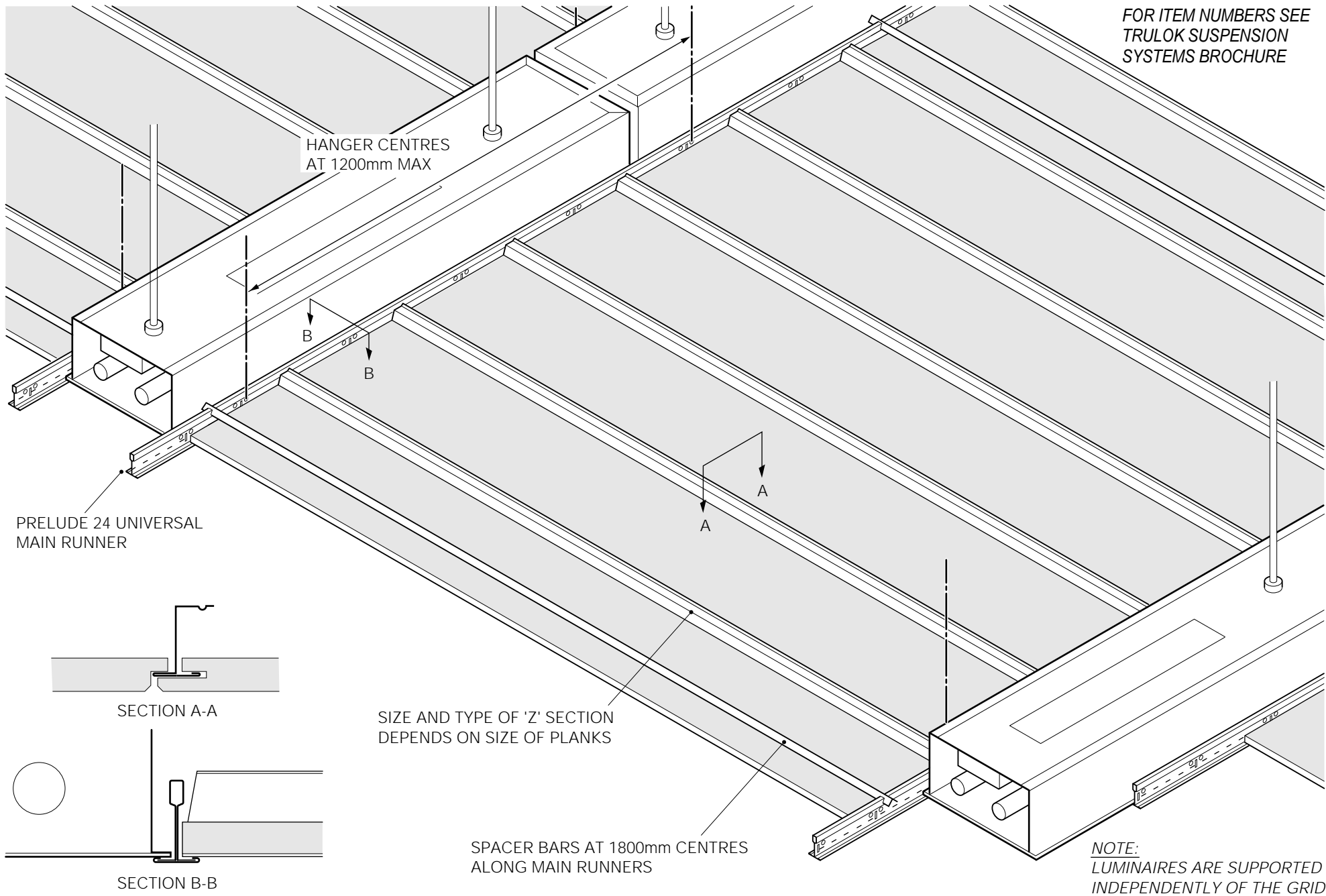

ARMSTRONG TRULOK  
SUSPENSION SYSTEMS

SL2 OR K2C2 PLANKS SPANNING BETWEEN  
CONTINUOUS LIGHTING TRUNKING

THESE DESIGNS ARE TYPICAL, NOT DEFINITIVE.  
ALL DIMENSIONS INDICATED ARE IN MILLIMETRES

T116

FOR ITEM NUMBERS SEE  
TRULOK SUSPENSION  
SYSTEMS BROCHURE

Armstrong

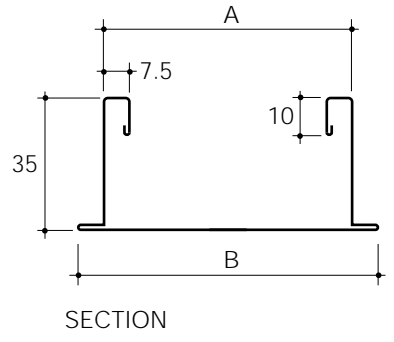
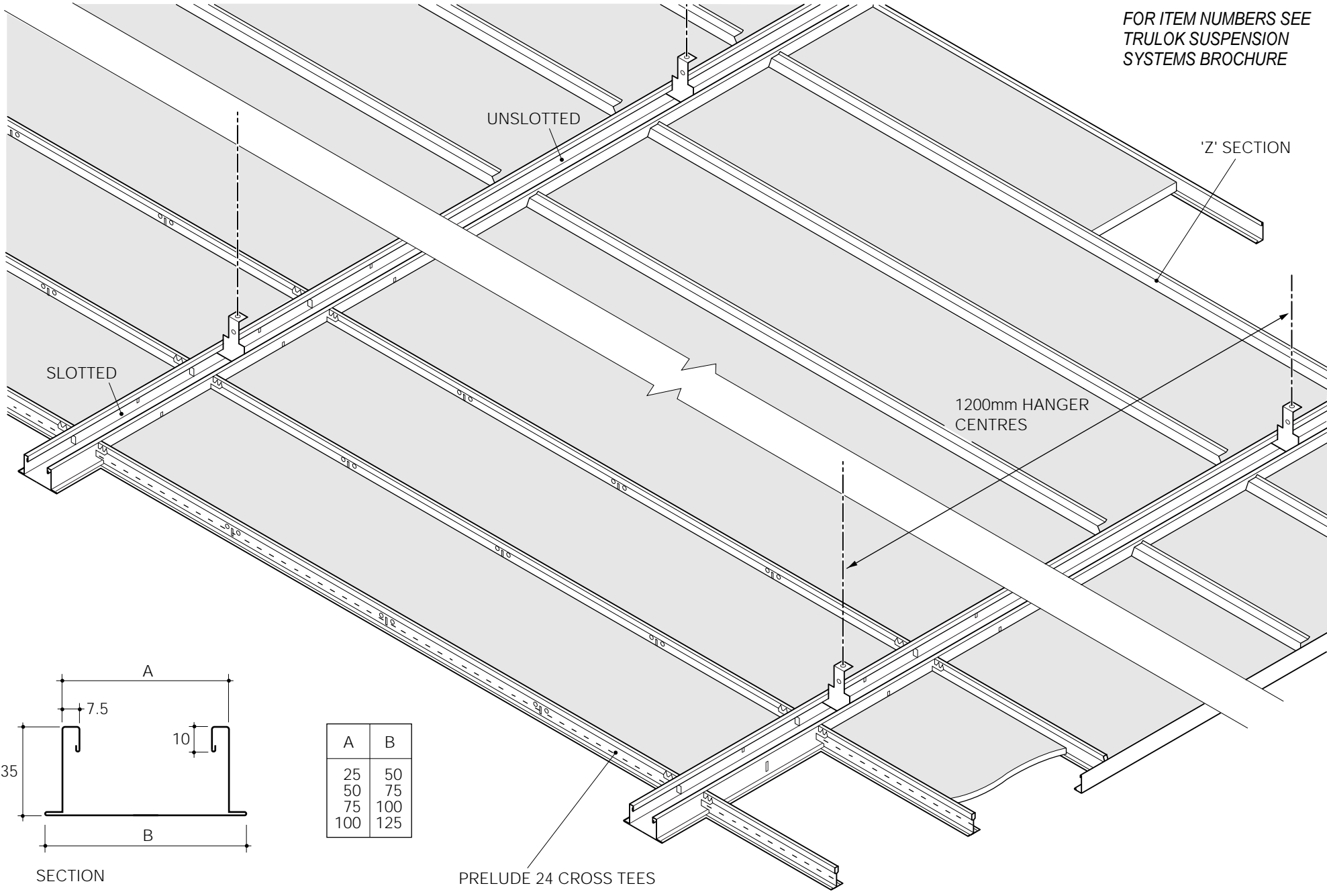

A	B
25	50
50	75
75	100
100	125

ARMSTRONG TRULOK  
SUSPENSION SYSTEMS

SLOTTED AND UNSLOTTED BANDRASTRER  
ASSEMBLIES FOR SL2 OR BOARD PLANK SYSTEMS

THESE DESIGNS ARE TYPICAL, NOT DEFINITIVE.  
ALL DIMENSIONS INDICATED ARE IN MILLIMETRES

T117

FOR ITEM NUMBERS SEE  
TRULOK SUSPENSION  
SYSTEMS BROCHURE

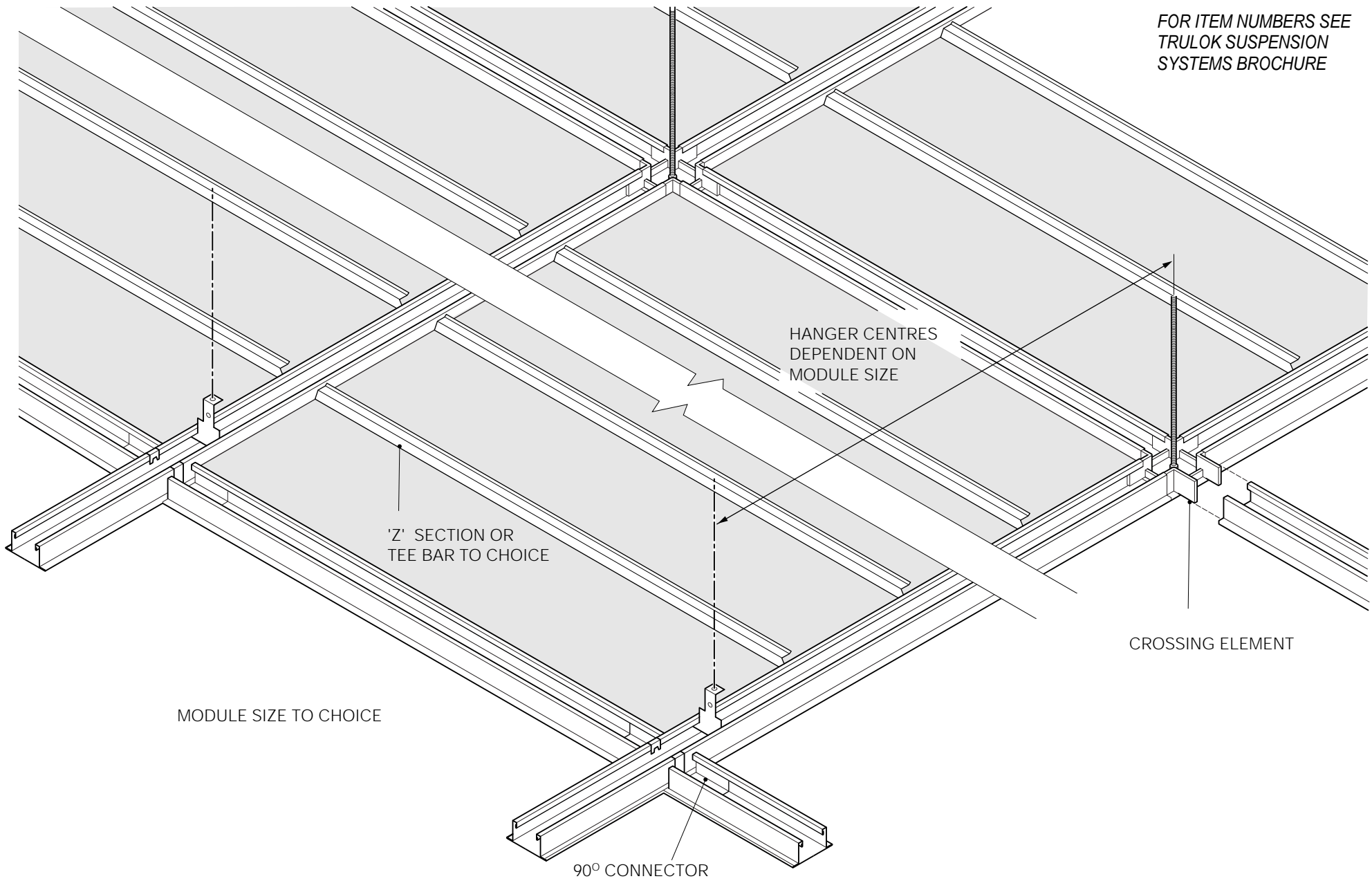

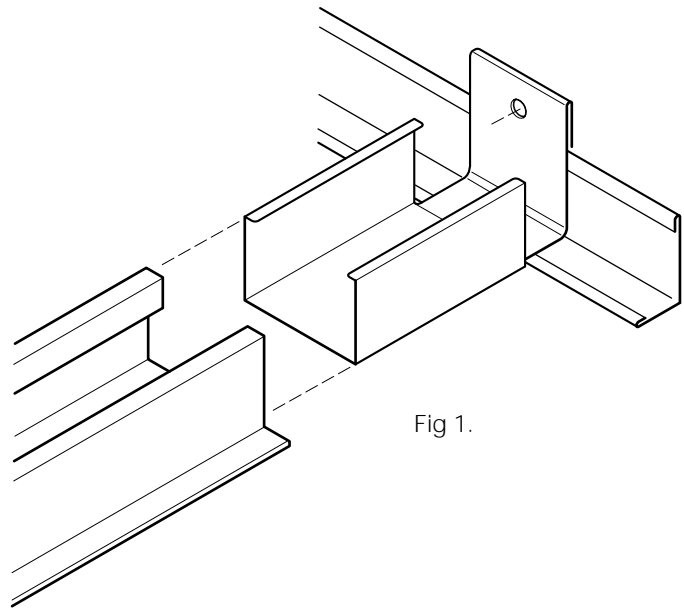

Fig 1.

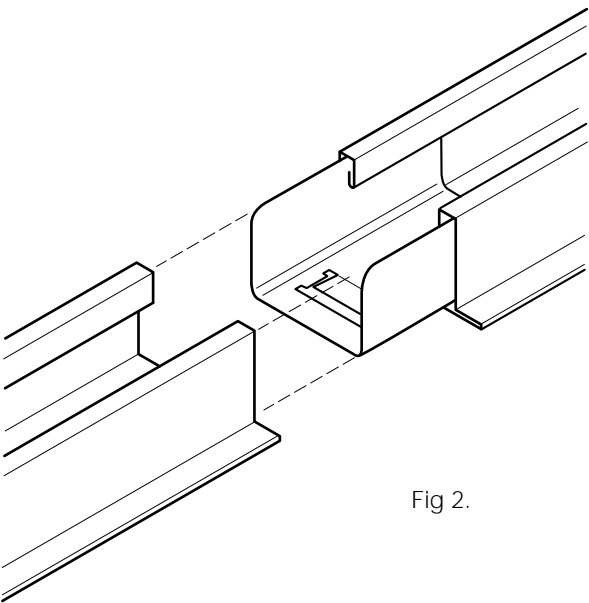

Fig 2.

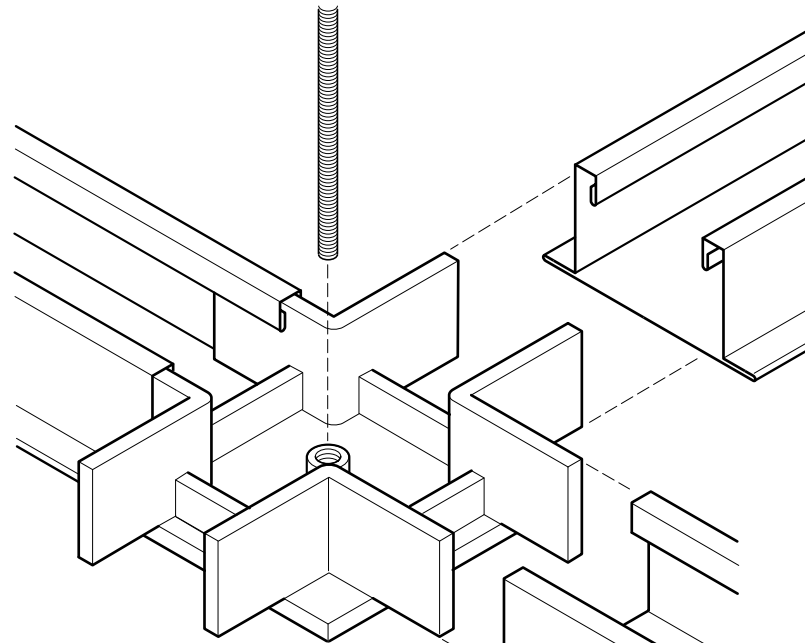

Fig 3.

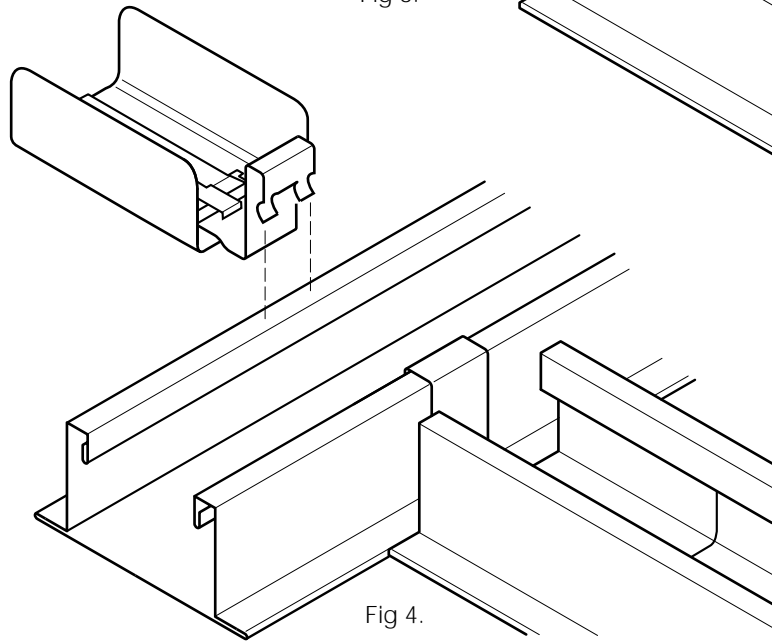

Fig 4.

FOR ITEM NUMBERS SEE  
TRULOK SUSPENSION  
SYSTEMS BROCHURE

Fig 1.  
WALL CONNECTOR.

Fig 2.  
SPLICE

Fig 3.  
CROSSING ELEMENT

Fig 4.  
90° CONNECTOR

FOR ITEM NUMBERS SEE  
TRULOK SUSPENSION  
SYSTEMS BROCHURE

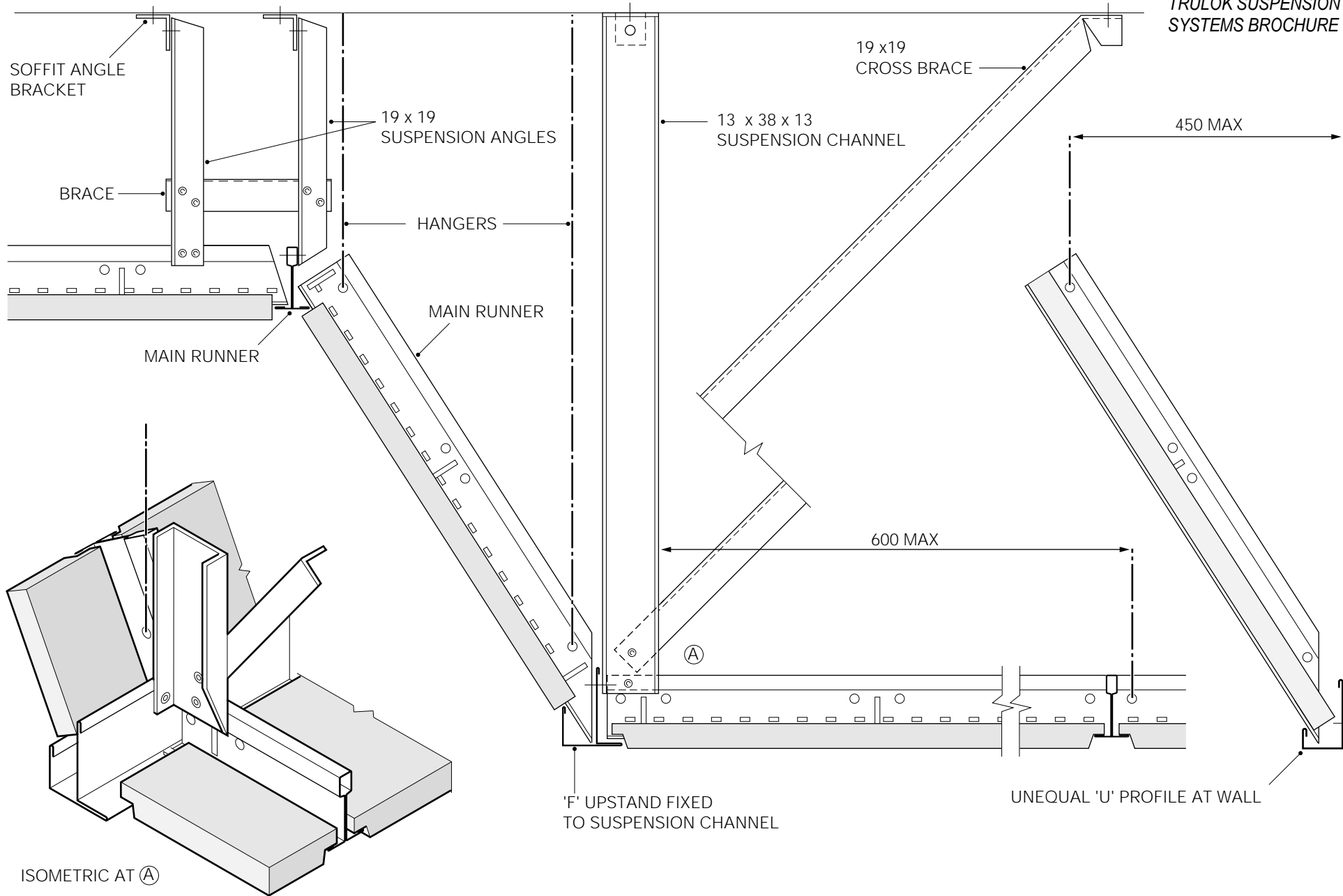

FOR ITEM NUMBERS SEE  
TRULOK SUSPENSION  
SYSTEMS BROCHURE

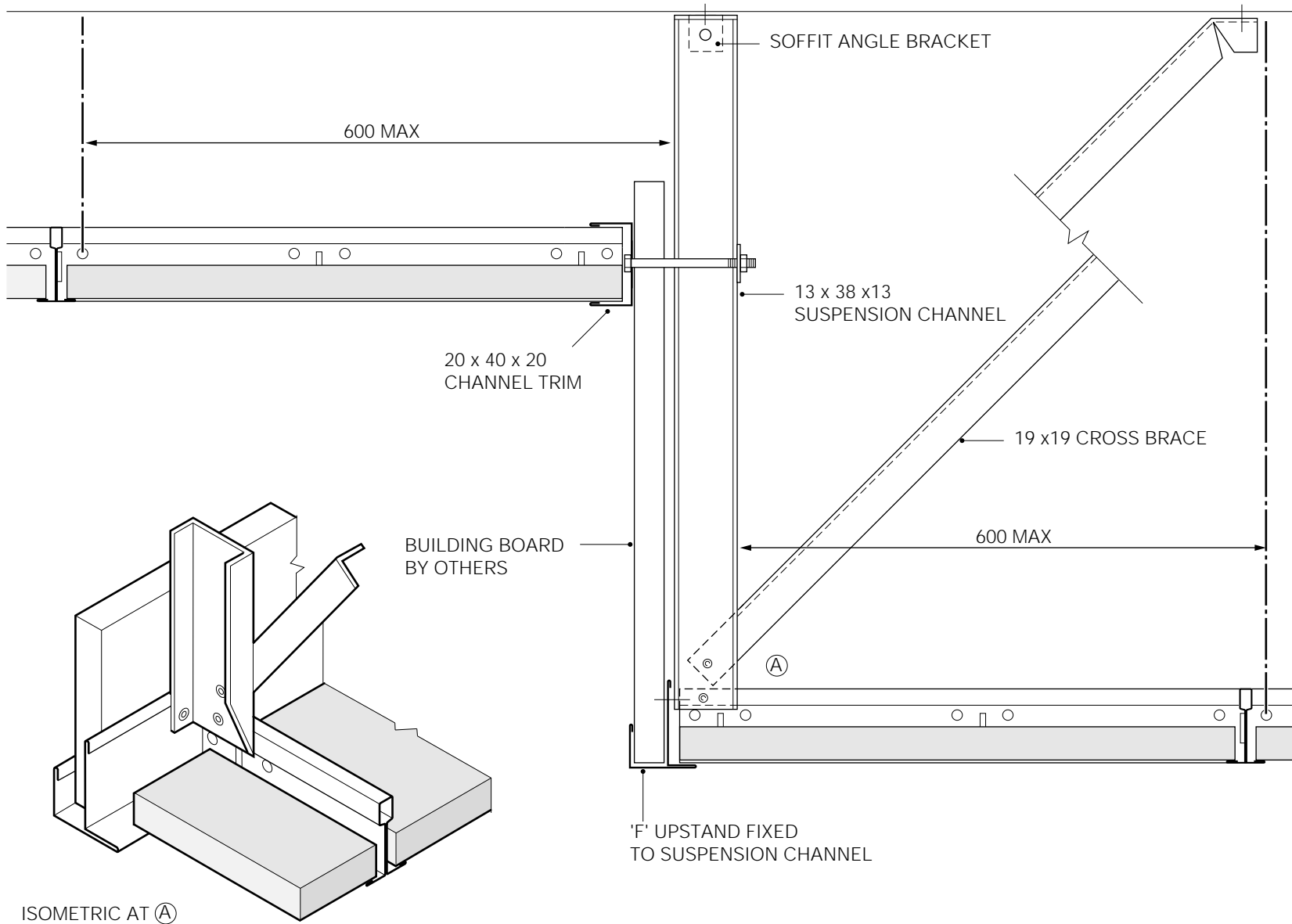

FOR ITEM NUMBERS SEE  
TRULOK SUSPENSION  
SYSTEMS BROCHURE

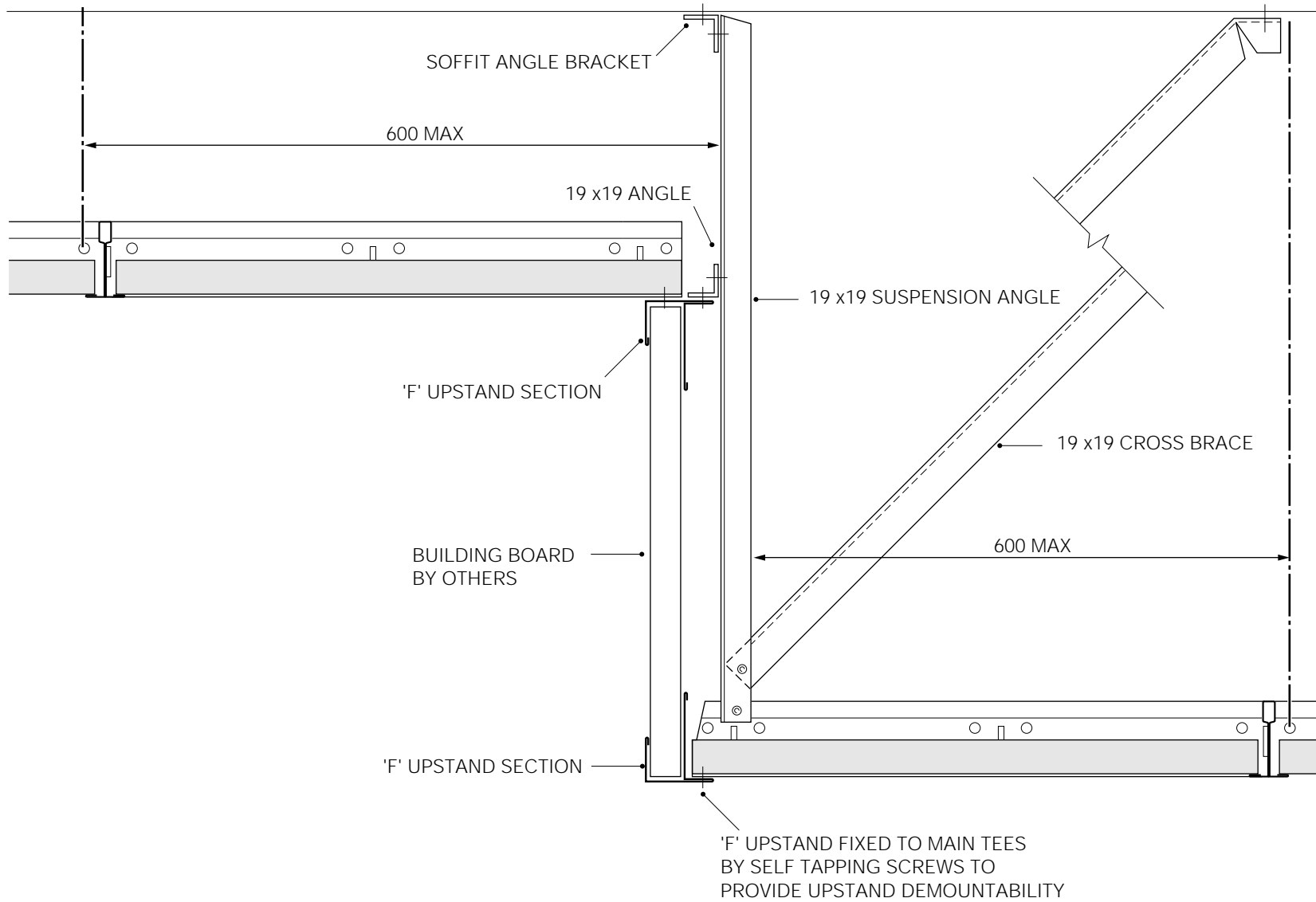

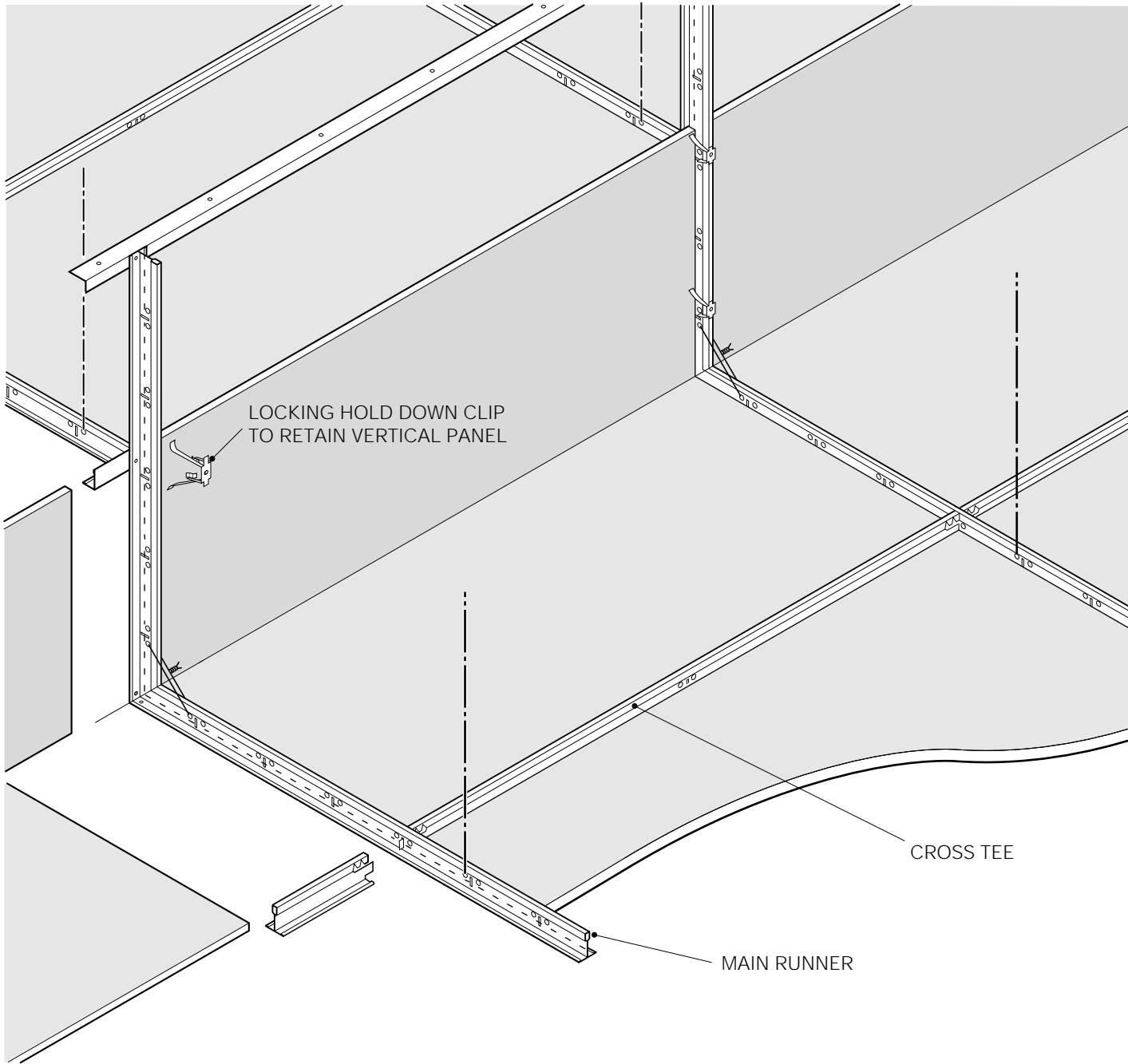

FOR ITEM NUMBERS SEE  
TRULOK SUSPENSION  
SYSTEMS BROCHURE

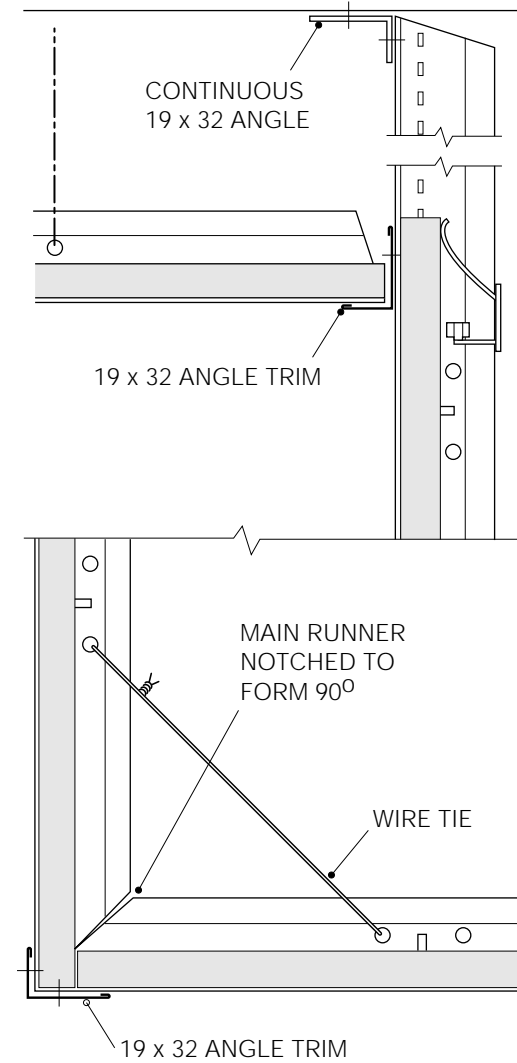

ARMSTRONG TRULOK  
SUSPENSION SYSTEMS

VERTICAL UPSTAND FOR PRELUDE 24 AND 15  
SUITABLE FOR UP TO 600mm HEIGHT

THESE DESIGNS ARE TYPICAL, NOT DEFINITIVE.  
ALL DIMENSIONS INDICATED ARE IN MILLIMETRES

Armstrong

T23



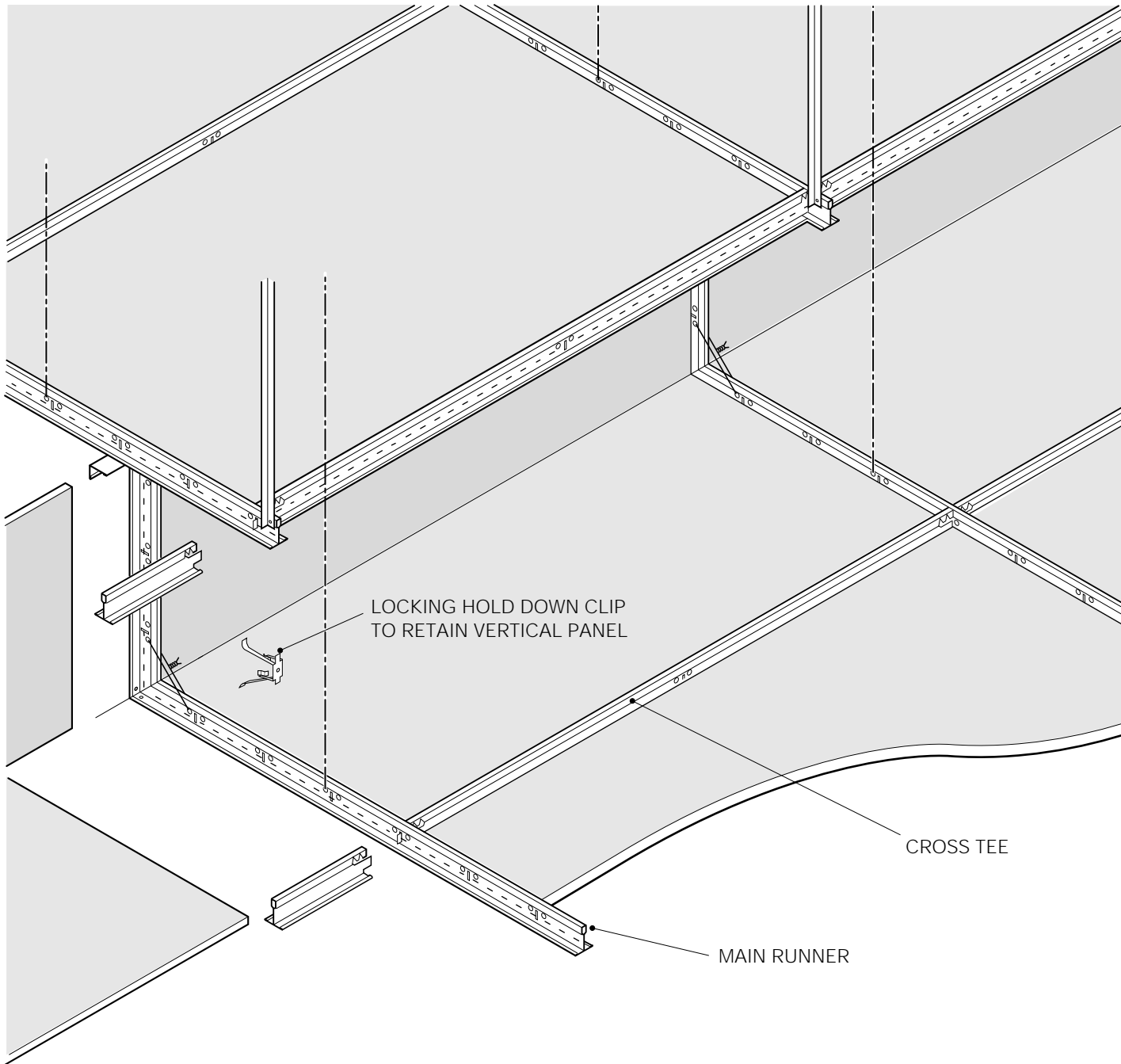

FOR ITEM NUMBERS SEE  
TRULOK SUSPENSION  
SYSTEMS BROCHURE

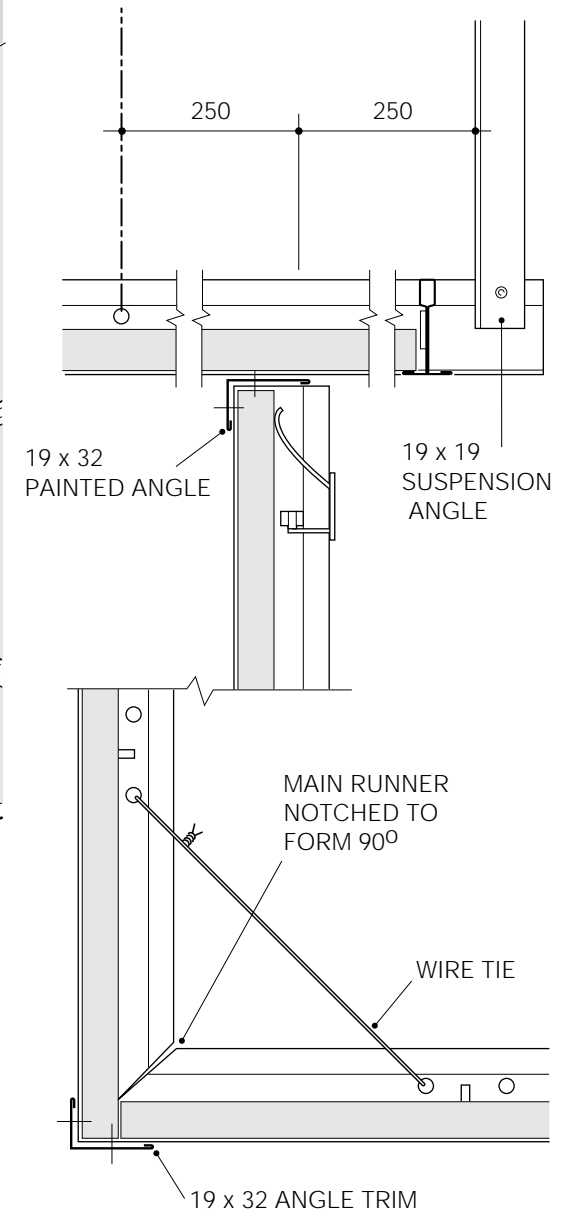

FOR ITEM NUMBERS SEE  
TRULOK SUSPENSION  
SYSTEMS BROCHURE

Armstrong

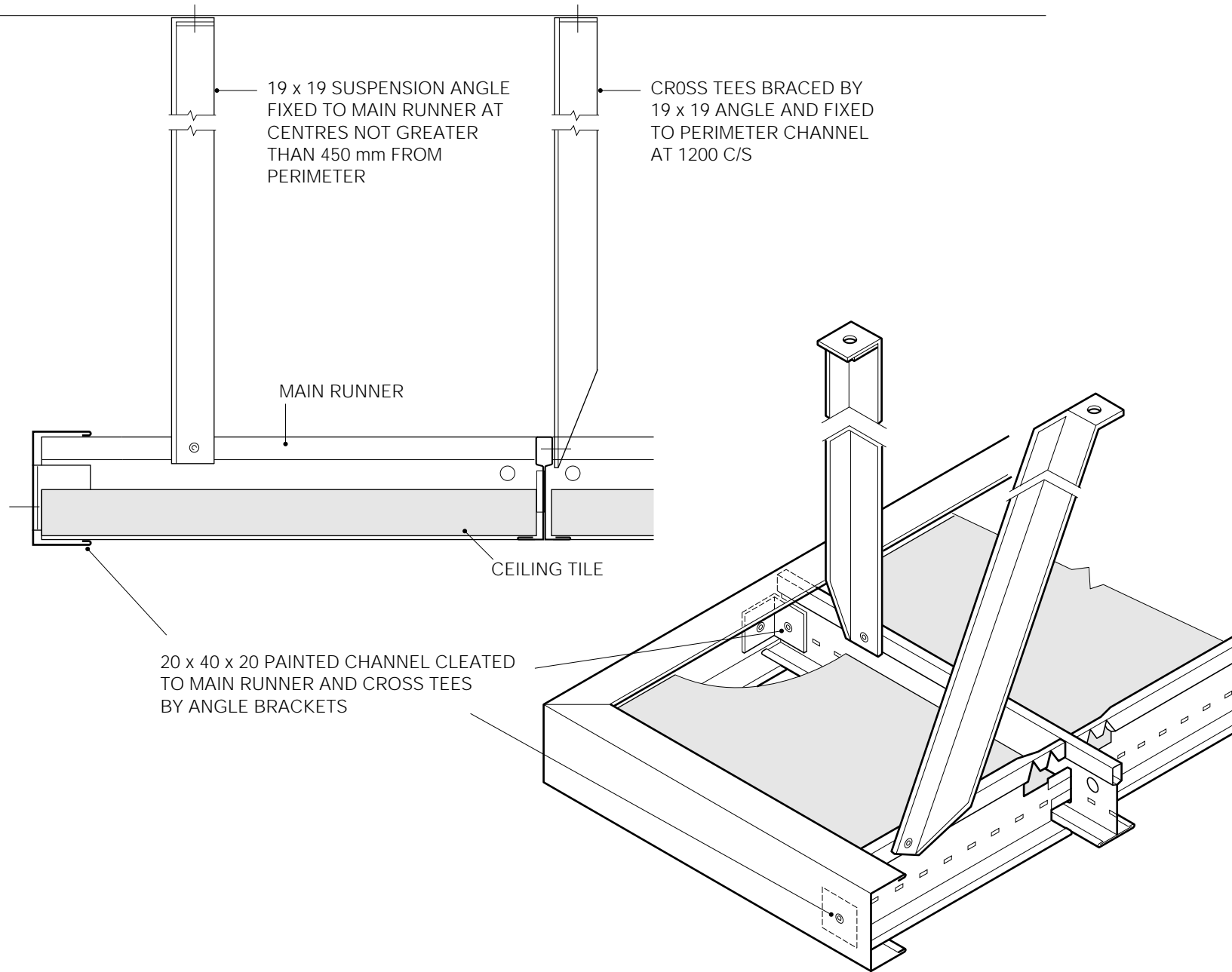

FOR ITEM NUMBERS SEE  
TRULOK SUSPENSION  
SYSTEMS BROCHURE

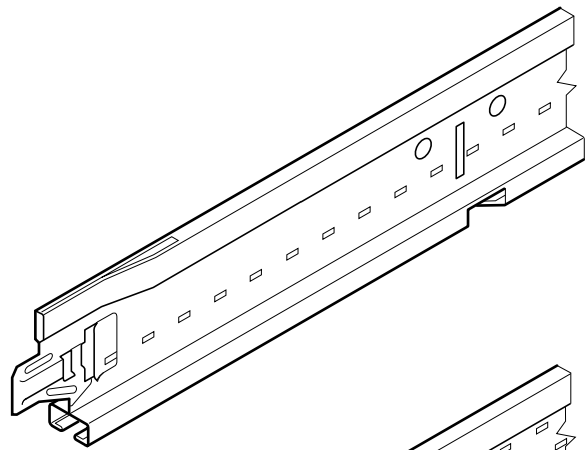

MAIN RUNNER

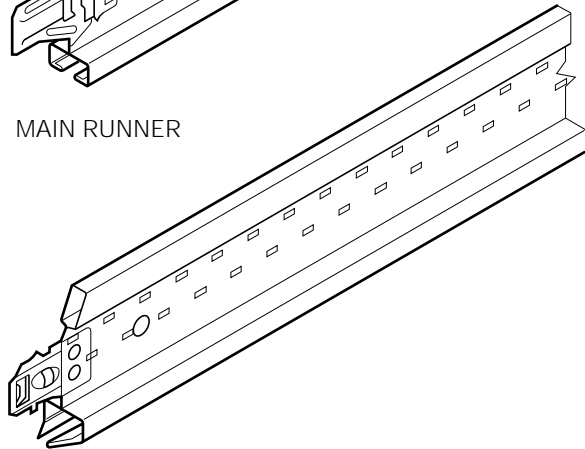
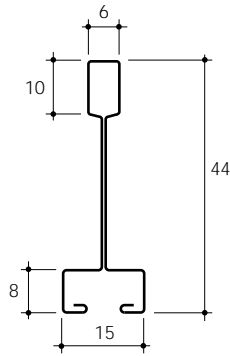

CROSS TEE

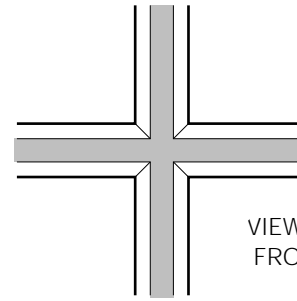
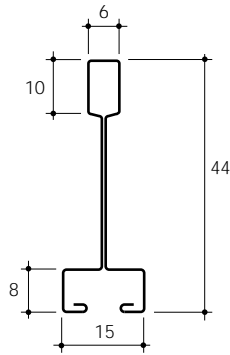

VIEW OF MITRED INTERSECTION  
FROM BENEATH

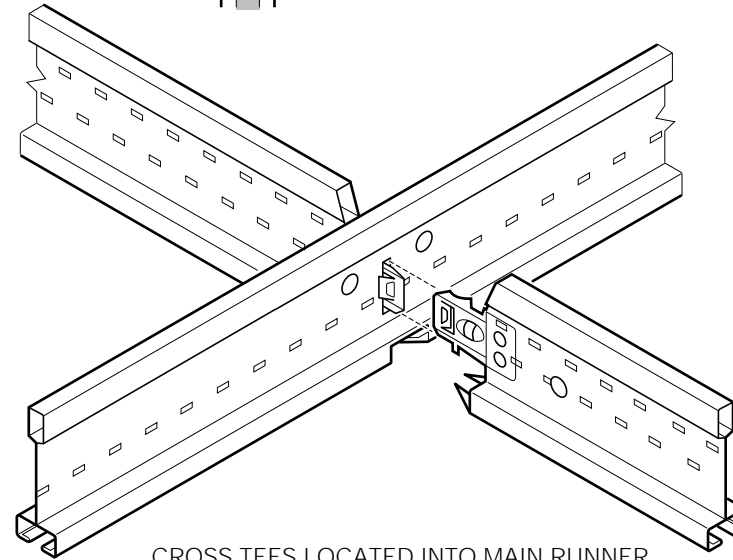

CROSS TEES LOCATED INTO MAIN RUNNER

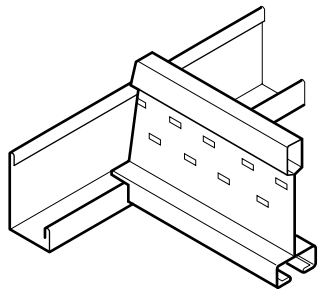

TEE CUT TO UNEQUAL  
U PROFILE AT PERIMETER

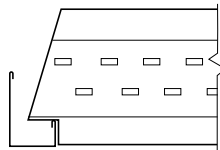

SECTION

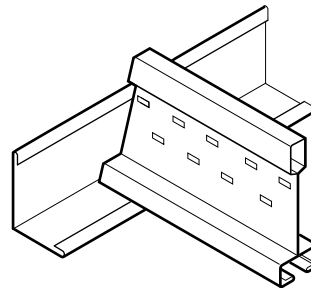

TEE TRIMMED TO  
WALL ANGLE

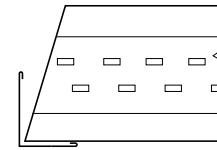

SECTION

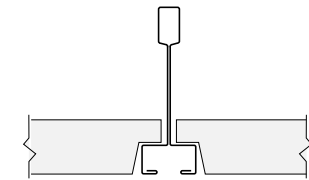

TYPICAL CROSS SECTION